



Agricultural Land Commission
133-4940 Canada Way
Burnaby, British Columbia V5G 4K6
Tel: 604 660-7000
Fax: 604 660-7033
www.alc.gov.bc.ca

April 14, 2015

ALC File: #53971

Michael Freisinger
PO Box 124
Procter, BC V0G 1V0

Dear Mr. Freisinger:

Re: Application to Conduct a Non-Farm Use on Land within the Agricultural Land Reserve (ALR)

Please find attached the Minutes of Resolution #76/2015 as it relates to the above noted application. The Commission has also attached a Sketch Plan depicting the decision.

Other approvals may be necessary. Prior to proceeding, the Commission suggests you contact your Local Government.

Further correspondence with respect to this application is to be directed to Lindsay McCoubrey (lindsay.mccoubrey@gov.bc.ca).

Yours truly,

PROVINCIAL AGRICULTURAL LAND COMMISSION

Per: 

Colin J. Fry, Chief Tribunal Officer

Enclosure(s): Minutes of Resolution #76/2015
Sketch Plan

53971d1



PROVINCIAL AGRICULTURAL LAND COMMISSION

Minutes of a meeting held by the Provincial Agricultural Land Commission (the "Commission") on Tuesday, April 14, 2015 at the offices of the Commission located at #133 – 4940 Canada Way, Burnaby, BC.

FOR CONSIDERATION

Application: 53971
Applicant: Michael Freisinger
Proposal: To construct an approximately 330 metre long access road through two properties to access a land locked third (PID: 011-798-661).
(Submitted pursuant to section 6 of BC Regulation #171/2002 (ALR Use, Subdivision and Procedure Regulation))

Legal: (1) PIN: 4202790 (Crown land)
(2) District Lot 3669, Similkameen Division Yale District (PID: 014-525-976)
(3) Sub Lot 6, District Lot 2701, Similkameen Division Yale District, Plan 1184 (PID: 011-798-661)

Location: Approximately 5.0 km northwest of Grand Forks

DELEGATION OF DECISION-MAKING TO THE CHIEF EXECUTIVE OFFICER (CEO)

On June 27, 2011 the Commission delegated decision-making to the CEO by Resolution #016N-2011 (File: 140-60/ALC/CEO/APPL). In accordance with section 27 of the *Agricultural Land Commission Act* the Commission has specified that the following applications may be decided by the CEO.

Criterion 4

Non-farm use applications made pursuant to section 6 of BC Regulation #171/2002 (ALR Use, Subdivision and Procedure Regulation)

DECISION:

After reviewing the entire file material, I, Brian Underhill, Deputy Chief Executive Officer of the Commission, am satisfied that the proposal is consistent with Criterion #4 of Resolution #016N/2011 and approve the application on behalf of the Commission.

This decision does not relieve the owner or occupier of the responsibility to comply with applicable Acts, regulations, bylaws of the local government, and decisions and orders of any person or body having jurisdiction over the land under an enactment.

RESOLUTION #76/2015

I CERTIFY THAT THIS IS A TRUE RECORD OF THE DECISION

Brian Underhill, Deputy Chief Executive Officer

Licence of Occupation

Legal Description Schedule

File No: 4405498

Disposition: 916574

That part of the surface of DISTRICT LOT 2701, SDYD, EXCEPT SUB-LOT 1, PLAN 1184, SUB-LOT 2, PLAN 1184, SUB-LOT 3, PLAN 1184, SUB-LOT 4, PLAN 1184, SUB-LOT 5, PLAN 1184, SUB-LOT 6, PLAN 1184, SUB-LOT 8, PLAN 1184, SUB-LOT 9, PLAN 1184, SUB-LOT 10, PLAN 1184, SUB-LOT 11, PLAN 1184, SUB-LOT 12, PLAN 1184, SUB-LOT 13, PLAN 1184, SUB-LOT 17, PLAN 1184, PLAN 534; lying within the boundaries of Lot 2169s, surveyed as the "Denver" Mineral Claim, Similkameen Division of Yale District, more particularly shown outlined in red and containing 0.260 hectares more or less.

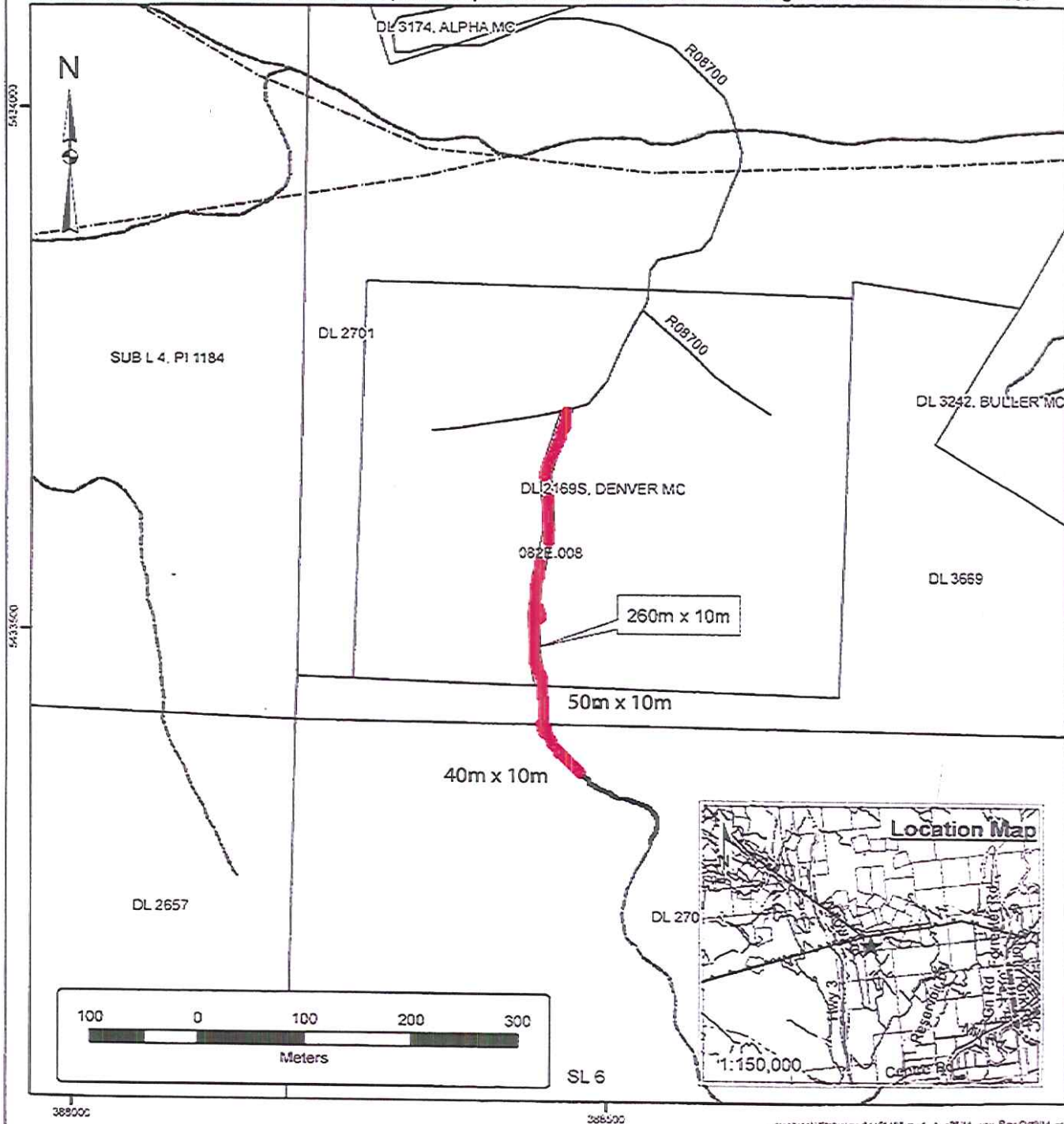

Scale 1:5,000
SCGS Mapsheet(s): 82E.008

4405498

Page ___ of ___

Map modified - April 14, 2015

RECEIVED
PROV. AGRICULTURAL
LAND COMMISSION
DEC 29 2014