



Agricultural Land Commission
133 – 4940 Canada Way
Burnaby, British Columbia V5G 4K6
Tel: 604 660-7000
Fax: 604 660-7033
www.alc.gov.bc.ca

June 28, 2012

Reply to the attention of
ALC File: 52782

Hermann Halvorson
Grindrod Recreation Association
c/o Regional District of North Okanagan
9848 Aberdeen Road
Coldstream, B.C.
V1B 2K9

Dear Sir:

Re: Application for a Community Hall in the Agricultural Land Reserve

Please find attached the Minutes of Resolution #222/2012 and a sketch plan outlining the Commission's decision as it relates to the above noted application. As agent, it is your responsibility to notify your client(s) accordingly.

Other approvals may be necessary. Prior to proceeding, the Commission suggests you contact any other authority that has jurisdiction.

Yours truly,

PROVINCIAL AGRICULTURAL LAND COMMISSION

Per:

A handwritten signature in black ink, appearing to read 'Brian Underhill', is written over a horizontal line.

Brian Underhill, Executive Director

Enclosure: Minutes/Sketch Plan



PROVINCIAL AGRICULTURAL LAND COMMISSION

A meeting was held by the Provincial Agricultural Land Commission on June 27th, 2012 at the offices of the Ministry of Agriculture in Kelowna.

COMMISSION MEMBERS PRESENT:

Richard Bullock	Chair
Jennifer Dyson	Vice-Chair
Bert Miles	Commissioner
Jim Johnson	Commissioner

COMMISSION STAFF PRESENT:

Martin Collins	Regional Planner
----------------	------------------

APPLICATION: # 52782

PROPOSAL: To construct a 1,800 sq ft community hall in Grindrod Recreation Park. The park is 3.4 ha in size and lies wholly within the ALR. The new building will be constructed adjacent to a concession building.

(Submitted pursuant to section 20(3) of the *Agricultural Land Commission Act*)

COMMISSION CONSIDERATION:

Section 6 of the *Agricultural Land Commission Act* identifies the purposes of the Commission are (1) to preserve agricultural land; (2) to encourage farming on agricultural land in collaboration with other communities of interest; and (3) to encourage local governments, first nations, the government and its agents to enable and accommodate farm use of agricultural land and uses compatible with agriculture in their plans, bylaws and policies.

After review of all file information presented, the Commission has concluded that there are no agricultural impacts associated with the new community hall building proposed for Grindrod Park. The longstanding park use is unlikely to change, and the proposed structure will not appreciably affect the dominant baseball, open field uses of the park.

In addition the Commission did not believe that the more intensive use of the park property for community hall events will have any significant impacts on the adjoining farm operation lying to the north. Though park usage may increase slightly as a result of a new hall, the longstanding park use; the significant separation of the new building from the ALR boundary; and existing fencing and vegetative screening between the farm and the park, all mitigate against potential conflicts.

IT WAS

MOVED BY:	Commissioner B. Miles
SECONDED BY:	Commissioner J. Dyson

THAT the application be allowed as proposed.

This decision does not relieve the owner or occupier of the responsibility to comply with applicable Acts, regulations, bylaws of the local government, and decisions and orders of any person or body having jurisdiction over the land under an enactment.

CARRIED

Resolution # 222/2012

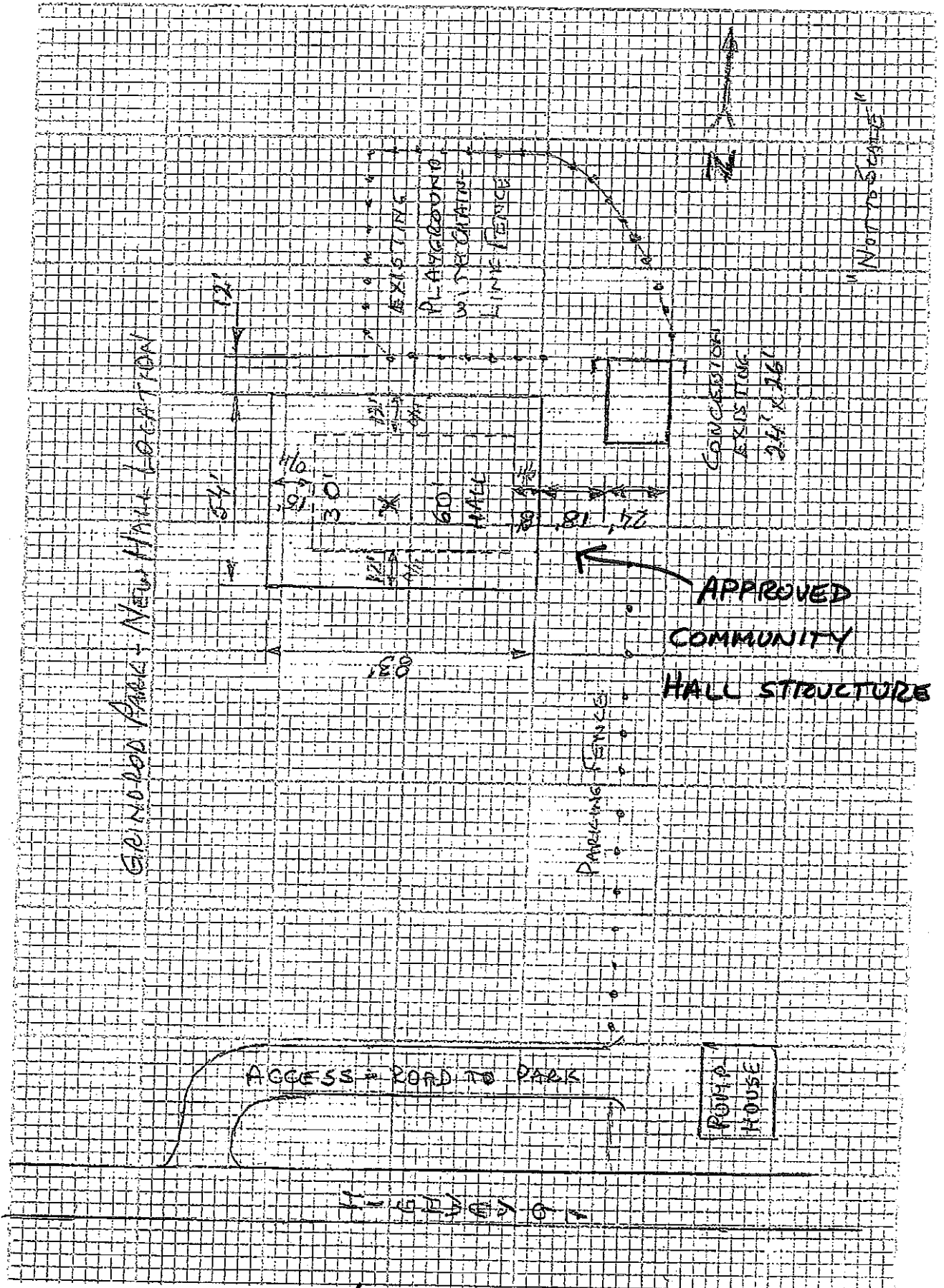

ALC APPLICATION # 52782 RES # 222/2012