



Agricultural Land Commission
133-4940 Canada Way
Burnaby, British Columbia V5G 4K6
Tel: 604 660-7000
Fax: 604 660-7033
www.alc.gov.bc.ca

September 8, 2011

Reply to the attention of Gordon Bednard
ALC File: 52436

Roy Northern Land and Environmental Ltd.
#207, 10139 – 100th St.
Fort St. John, B.C.
V1J 3Y6

Dear Sir/Madam:

Re: Application for Non Farm Uses in the Agricultural Land Reserve

Please find attached the Minutes of Resolution #314/2011 and a sketch plan outlining the Commission's decision as it relates to the above noted application. As agent, it is your responsibility to notify your client(s) accordingly.

Other approvals may be necessary. Prior to proceeding, the Commission suggests you contact you're the Peace River Regional District or any other authority that has jurisdiction. .

Yours truly,

PROVINCIAL AGRICULTURAL LAND COMMISSION

Per:

A handwritten signature in black ink, appearing to read 'Brian Underhill', written over a white background.

Brian Underhill, Executive Director

Enclosure: Minutes/Sketch Plan/Schedule B

cc: Peace River Regional District File #119/2011

MC/52436/d1



PROVINCIAL AGRICULTURAL LAND COMMISSION

Minutes of a meeting held by the Provincial Agricultural Land Commission (the "Commission") on September 8, 2011 at the offices of the Commission located at #133 – 4940 Canada Way, Burnaby, BC.

FOR CONSIDERATION

Application: (Submitted pursuant to section 20(3) of the *Agricultural Land Commission Act*)

Application: 52436
Applicant: Talisman Energy
Agent: Roy Northern Land and Environment
Proposal: To use 14.05 ha for a super pad well site. The area exceeds the permitted 7 ha per ¼ section permitted by the OGC Delegation Agreement.
Legal: SW ¼ Sec. 34, Twp 83, R. 25, W6M, PRD
NW ¼ Sec. 27, Twp 83, R. 25 W6M, PRD
Location: 8 km north of Hudson's Hope
Background: No previous applications – not located in an agricultural area
Attachment: Airphoto, ALC Context map, and sketch

DELEGATION OF DECISION-MAKING TO THE CHIEF EXECUTIVE OFFICER (CEO)

On January 26, 2011 the Commission delegated decision-making to the CEO by Resolution #008N-2011 (File: 135-45/ALC/CEO/APPL). In accordance with section 27 of the *Agricultural Land Commission Act* the Commission has specified that the following applications may be decided by the CEO.

Criterion 11

Non-farm use applications for compressor stations for oil and gas development that exceed 450 m²; 5th or greater stand alone well sites (including associated roads, temporary camps, sumps, borrow pits etc) and well site applications where the area exceeds 7 ha. All other oil and gas-related applications such as processing facilities, drilling and production waste handling, produced water and gas handling; commercial waste handling and disposal facilities will continue to be referred directly to the panel for decision making; and

DECISION:

After reviewing the entire file material, I, Richard Bullock, Chief Executive Officer of the Commission, am satisfied that the proposal is consistent with Criterion # 11 of Resolution #008N/2011 and approve the application on behalf of the Commission.

Approval is subject to the following conditions:

- The non farm use be confined to the areas identified on the plan submitted with the application.
- Construction must be commenced within three years of the date of the decision.
- Reclamation of the well site to a similar or better standard so that the land can be used for agricultural purposes upon decommissioning of the well. Reclamation must

meet the standards set out in the Schedule B (attached) and a report based on the Schedule B must be submitted to the Commission following reclamation.

- Approval is provided to the applicant only and is non transferable.

RESOLUTION # 314/2011

I CERTIFY THAT THIS IS A TRUE RECORD OF THE DECISION



Richard Bullock, Chief Executive Officer

Talisman Energy Inc.
 Talisman HZ Altares Well Site
 13-27-83-25, W6M
 Site Sketch

ALC APPLICATION
 # 52436

ALC RESOLUTION
 # 314/2011

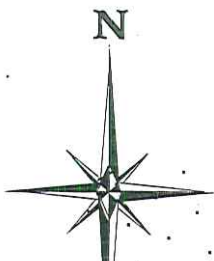

APPROVED WELLSITE, ROAD, BORROW PIT

NW Cor
 Sec 27

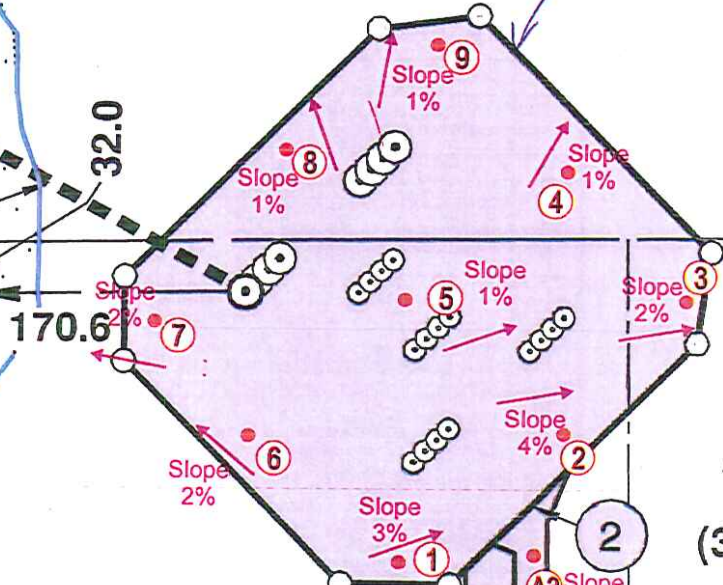

PROPOSED
 20 x 535m
 ACCESS ROAD
 WITH
 (3) 20m CUT-OFFS

PROPOSED
 0.21 ha
 LOG DECK

NW
 SEC 27

PROPOSED
 60 x 100m
 BORROW PIT

PROPOSED
 0.19 ha
 LOG DECK

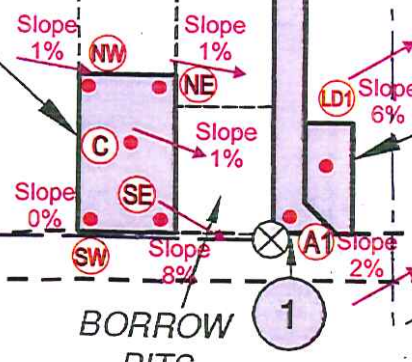

BORROW
 PITS

2011 PNG

Legend

- Slope Direction
- Assessment Point
- Drainage
- Wet Area

*Sketch is not to scale