



**Agricultural Land Commission**  
133-4940 Canada Way  
Burnaby, British Columbia V5G 4K6  
Tel: 604 660-7000  
Fax: 604 660-7033  
www.alc.gov.bc.ca

August 5, 2010

Reply to the attention of Simone Rivers  
ALC File: 51814

Kenneth MacDougall  
Box 645  
Barriere, B.C. V0E 1E0

Dear Mr. MacDougall:

**Re: Application to Include land in the Agricultural Land Reserve**

Please find attached the Minutes of Resolution # **2593/2010** outlining the Commission's decision as it relates to the above noted application.

The Commission noted on the diagram submitted with the inclusion application that the location of the approved lot had been changed slightly from what was shown on the original approval letter. Staff recalled a discussion with yourself in which you had asked permission to square the boundaries of the lot in order to reduce the cost of surveying. Staff had indicated that this change would be appropriate.

However, upon review of the inclusion file, the Commission wished to reiterate that its position when it allowed the 2 ha subdivision was to contain the development to the lower hayfield next to the highway and to preserve the upper field as a single unit. Therefore, while it had no objection to the creation of a square or rectangular lot, the lot must not contain any significant portion of the upper hay field. Therefore, due to the topographical constraints, the shape of the lot likely must be longer in the north-south direction than in the east-west direction (as shown on the sketch submitted with the inclusion application).

Staff suggests you send a preliminary survey plan of the lot to the Commission prior to submission of the final survey plans to ensure that the revised lot layout is consistent with the Commission's resolution.

Yours truly,

PROVINCIAL AGRICULTURAL LAND COMMISSION

Per:

A handwritten signature in black ink that reads 'Simone Rivers'. The signature is written in a cursive, flowing style.

Brian Underhill, Executive Director

Enclosure: Minutes/Sketch Plan

cc: Thompson-Nicola Regional District  
File ZZ-38777

SBR/  
/51814d1/

ALC Application # 51814 Resolution # 2593/2010

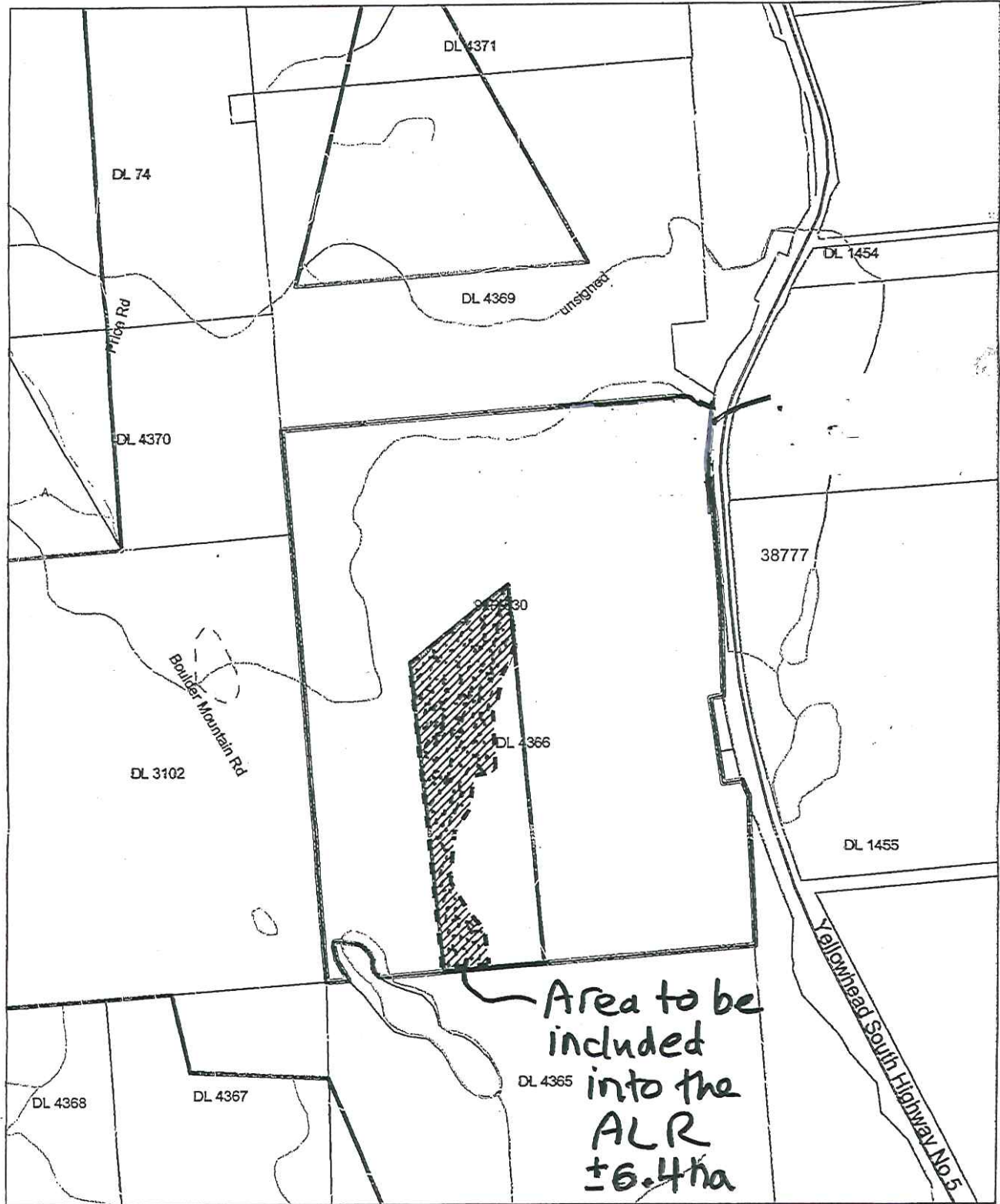

Scale: 1: 10,000  
BCGS Mapsheet(s): 92P.030

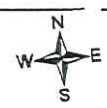



## MINUTES OF THE PROVINCIAL AGRICULTURAL LAND COMMISSION

---

**A meeting was held by the Provincial Agricultural Land Commission on August 5, 2010.**

**PRESENT:** Gordon Gillette                                      Chair, Interior Panel  
                  Lucille Dempsey                                      Commissioner  
                  Simone Rivers    Staff

### **For Consideration**

Application:            51814  
Applicant:             Ken MacDougall  
Proposal:              To include approximately 6.4 ha into the ALR. The application was made to fulfill a condition of Commission Resolution # 137/2009  
Legal:                  PID: 023-109-599  
                              Lot A, District Lot 4366 and 4369, Kamloops Division Yale District, Plan KAP55004  
Location:              North of Barriere on Highway 5.

### **Discussion**

The Commission had no objection to the inclusion of the land as it fulfilled a condition of approval of Resolution # 137/2009.

### **IT WAS**

**MOVED BY:**            Commissioner Gillette  
**SECONDED BY:**        Commissioner Dempsey

THAT the application be approved.

This decision does not relieve the owner or occupier of the responsibility to comply with applicable Acts, regulations, bylaws of the local government. This includes zoning, subdivision, or other land use bylaws, and decisions of any authorities that have jurisdiction under an enactment.

### **CARRIED**

**Resolution # 2593/2010**