



Agricultural Land Commission
133-4940 Canada Way
Burnaby, British Columbia V5G 4K6
Tel: 604 660-7000
Fax: 604 660-7033
www.alc.gov.bc.ca

13th January 2010

Reply to the attention of Gordon Bednard
ALC File: 50520

Steve Wohlleben
C/o 1235 Honeysuckle Lane
Gabriola Island, BC
V0R 1X3

Dear Sir:

Re: Application for Inclusion into the Agricultural Land Reserve and Subdivision in the Agricultural Land Reserve

Please find attached the Minutes of Resolution # 1887/2009 outlining the Commission's decision as it relates to the above noted application. By way of a copy of this letter, the Commission is advising the Registrar of Land Titles of its order and confirming that the ALR notation is to be added to Certificate of Title # EW41409

Please send two (2) paper prints of the final survey plans to this office. When the Commission confirms that all conditions have been met, it will authorize the Registrar of Land Titles to accept registration of the plan.

Other approvals may be necessary. Prior to proceeding, the Commission suggests you contact your Local Government.

Yours truly,

PROVINCIAL AGRICULTURAL LAND COMMISSION

Per:

A handwritten signature in black ink, appearing to read 'Erik Karlsen', is written over the 'Per:' label. The signature is fluid and cursive.

Erik Karlsen, Chair

Enclosure: Minutes/Sketch Plan

cc Islands Trust Salt Spring Island
BC Land Title & Survey, Victoria

rc/
i/50520d1

Page 2 of 2 Resolution # 1886/2009
Application # 50520

subdivision, or other land use bylaws, and decisions of any authorities that have jurisdiction under an enactment.

CARRIED
Resolution # 1887/2009

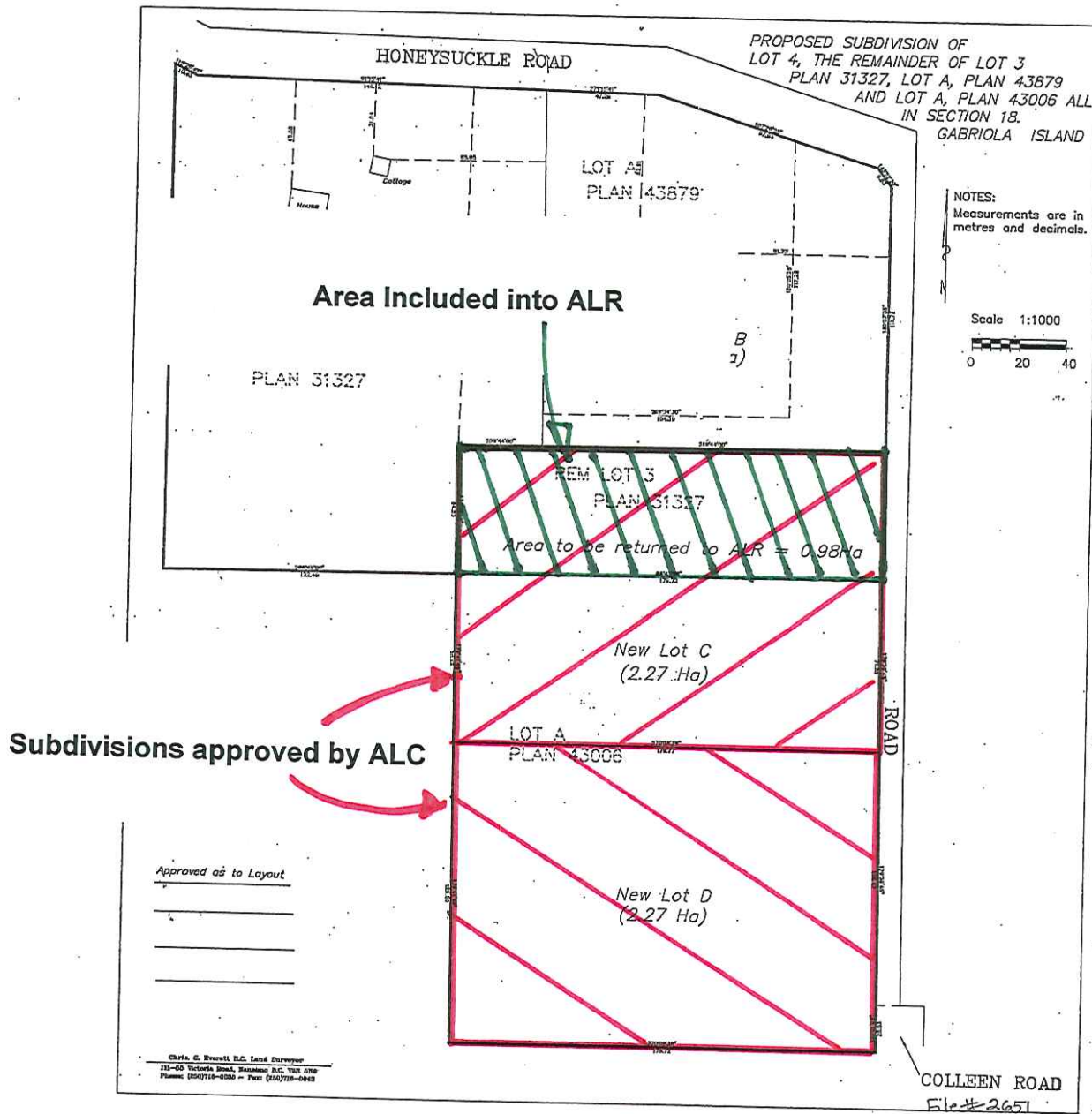

Subdivisions approved by ALC

ALC APPLICATION: 50520

ALC Resolution Number 1887/2009