



**Agricultural Land Commission**  
133-4940 Canada Way  
Burnaby, British Columbia V5G 4K6  
Tel: 604 660-7000  
Fax: 604 660-7033  
www.alc.gov.bc.ca

November 5, 2009

Reply to the attention of Martin Collins  
ALC File: 50692

Michael Sosnowski  
3452 Anderson Road  
Ferne, B.C.  
V0B 1M1

Dear Sir:

**Re: Application to Place Fill on Land in the Agricultural Land Reserve**

Please find attached the Minutes of Resolution # 1289/2009 and a sketch plan outlining the Commission's decision as it relates to the above noted application

Other approvals may be necessary. Prior to proceeding, the Commission suggests you contact your Local Government.

Yours truly,

PROVINCIAL AGRICULTURAL LAND COMMISSION

Per:

A handwritten signature in black ink, appearing to read 'Erik Karlsen', written over a horizontal line.

Erik Karlsen, Chair

Enclosure: Minutes/Sketch Plan

cc: Regional District of East Kootenay (File P709 108)

MC//50692d1



The limiting subclasses are topography and seasonal moisture deficiency

The Commission believed that the 1.5 ha property had very limited capability or suitability for agricultural development because of its small size.

### **Assessment of Impact on Agriculture**

The Commission also assessed the impact of the proposal against the long term goal of preserving agricultural land. The Commission believes the proposal would not affect the existing or potential agricultural use of surrounding lands because there is little, if any agricultural activity occurring in the area. Also a sand pile is temporary and does not represent a severe debilitation of the agricultural potential of the property.

It was also noted by the Commission that the property lies in an area proposed for exclusion in the Elk Valley Review.

### **Conclusions**

1. That the land under application has very limited agricultural capability and is unsuitable for agricultural uses.
2. That the fill proposal will not impact agriculture.

### **IT WAS**

**MOVED BY:** Commissioner C. Purdy

**SECONDED BY:** Commissioner E. Karlsen

THAT the application to place 2,000 cubic meters on a 0.2 ha portion of the 1.5 ha lot be allowed for a four year period.

And that the decision be subject to the following condition.

- the sand must be removed four (4) years from the date of this decision.

This decision does not relieve the owner or occupier of the responsibility to comply with applicable Acts, regulations, bylaws of the local government. This includes zoning, subdivision, or other land use bylaws, and decisions of any authorities that have jurisdiction under an enactment.

### **CARRIED**

**Resolution # 1289/2009**

# Regional District of East Kootenay

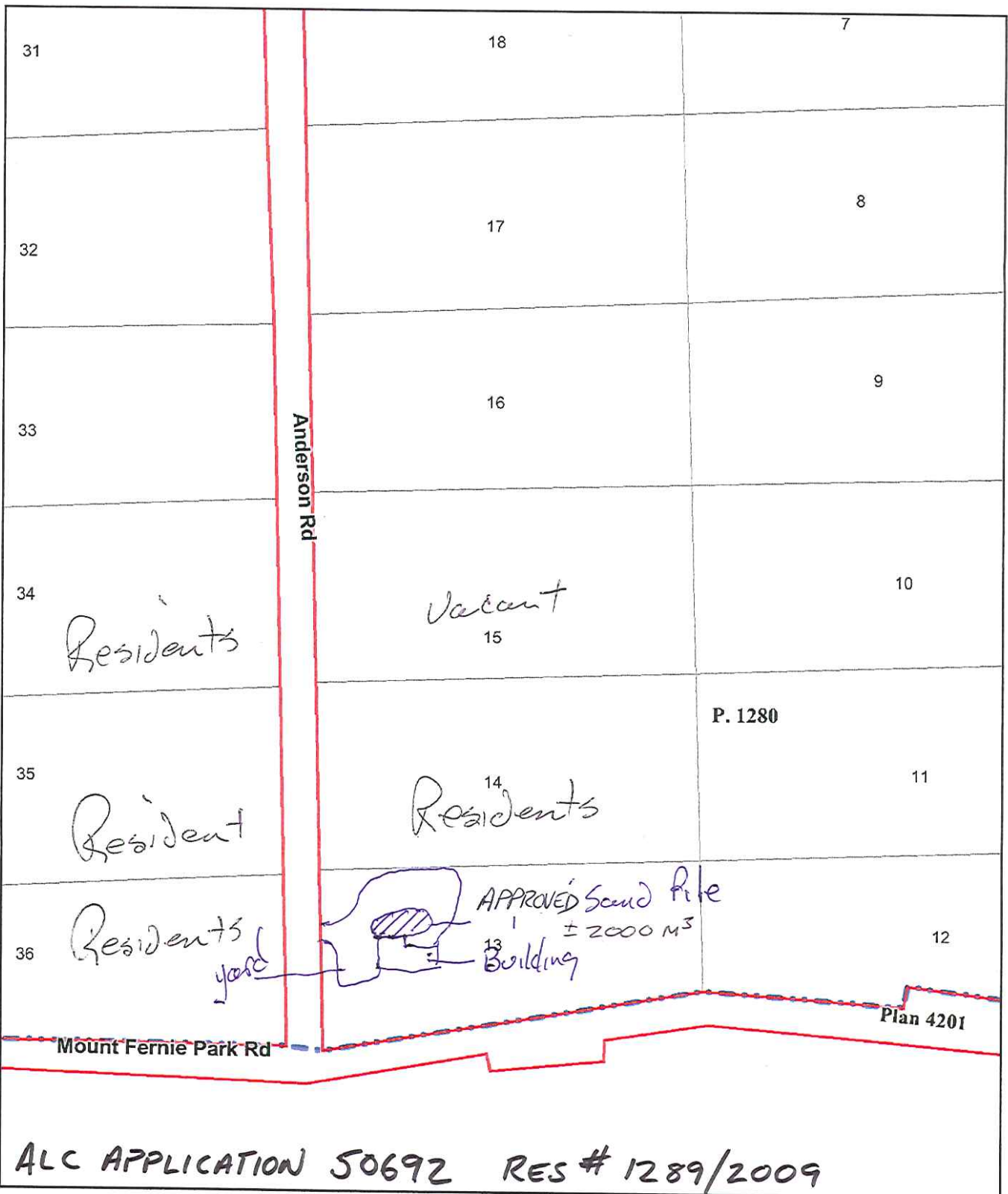

0 55 110 m.

Map center: 638642, 5483566



Scale: 1:3,000

This map is a user generated static output from an Internet mapping site and is for general reference only. Data layers that appear on this map may or may not be accurate, current, or otherwise reliable. THIS MAP IS NOT TO BE USED FOR NAVIGATION.