



**Agricultural Land Commission**  
133-4940 Canada Way  
Burnaby, British Columbia V5G 4K6  
Tel: 604 660-7000  
Fax: 604 660-7033  
www.alc.gov.bc.ca

November 9, 2009

Reply to the attention of Martin Collins  
ALC File: 50224

Clint and Cindy Pighin  
7650 Mission Road  
Cranbrook, BC  
V1C 7E5

Dear Sir/Madam:

**Re: Application to Subdivide within the Agricultural Land Reserve**

Please find attached the Minutes of Resolution # 1282/2009 and a sketch plan outlining the Commission's decision as it relates to the above noted application.

Other approvals may be necessary. Prior to proceeding, the Commission suggests you contact your Local Government.

Yours truly,

PROVINCIAL AGRICULTURAL LAND COMMISSION

Per:

A handwritten signature in black ink, appearing to read 'Erik Karlsen', written over a horizontal line.

Erik Karlsen, Chair

Enclosure: Minutes/Sketch Plan

cc: Regional District of East Kootenay (File 709 316)

MC/i/50224d1



- Class 3 – Land in this class has limitations that require moderately intensive management practices or moderately restrict the range of crops, or both.
- Class 4 – Land in this class has limitations that require special management practices or severely restrict the range of crops, or both.

The limiting subclasses are seasonal moisture deficiency and stoniness. The soil has capability for agricultural uses and is currently developed for pasture/hayfield.

### **Assessment of Impact on Agriculture**

The Commission also assessed the impact of the proposal against the long term goal of preserving agricultural land. The Commission believes the proposal represents a benefit for agriculture because the son is involved in the farm operation. In addition the area of the 2 ha lot not used for the home and yard would remain in hay production.

### **Conclusions**

1. That the land under application has good agricultural capability and is suitable for agricultural uses.
2. That the subdivision proposal will not impact agriculture.

### **IT WAS**

**MOVED BY:** Commissioner J. Thibeault

**SECONDED BY:** Commissioner B. Minor

THAT the application to subdivide a 2 ha lot from the subject properties be allowed.

And that the decision be subject to the following condition.

- the subdivision must be completed within three (3) years from the date of this decision.

This decision does not relieve the owner or occupier of the responsibility to comply with applicable Acts, regulations, bylaws of the local government. This includes zoning, subdivision, or other land use bylaws, and decisions of any authorities that have jurisdiction under an enactment.

### **CARRIED**

**Resolution # 1282/2009**



# Regional District of East Kootenay

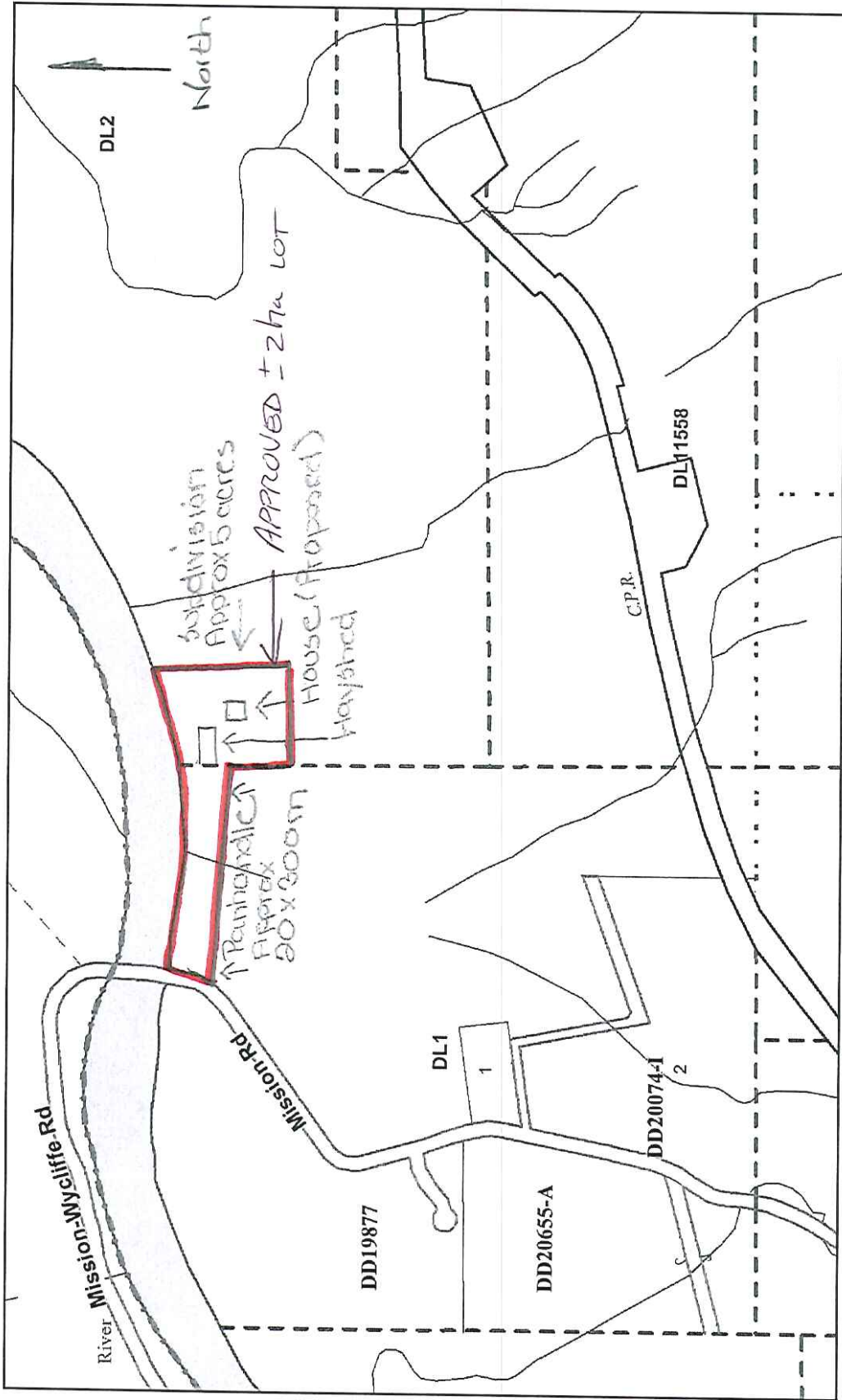

Map center: 590603, 5493327

This map is a user generated static output from an Internet mapping site and is for general reference only. Data layers that appear on this map may or may not be accurate, current, or otherwise reliable. THIS MAP IS NOT TO BE USED FOR NAVIGATION.

ALL APPLICATION # 50224  
RESOLUTION # 1282/2009