



Agricultural Land Commission
133-4940 Canada Way
Burnaby, British Columbia V5G 4K6
Tel: 604 660-7000
Fax: 604 660-7033
www.alc.gov.bc.ca

February 20, 2009

Reply to the attention of Jennifer Carson
ALC File: Q-38685

Chris Everett
111-55 Victoria Road
Nanaimo, BC V9R5N9

Dear Mr. Everett:

Re: Application to Exclude land from the Agricultural Land Reserve

Please find attached the Minutes of Resolution # 16/2009 outlining the Commission's decision as it relates to the above noted application. As agent, it is your responsibility to notify your client(s) accordingly.

By way of a copy of this letter, the Commission is advising the Registrar of Land Titles of its order and confirming that the ALR notation is to be removed from Certificate of Title CA818070.

Yours truly,

PROVINCIAL AGRICULTURAL LAND COMMISSION

Per: 

Erik Karlsen, Chair

Enclosure: Minutes/Sketch Plan

cc: Regional District of Kootenay-Boundary (E-775s-04182-000)
BC Land Title & Survey,
BC Assessment,

JC/
i/38685d1

Conclusion

That the proposal will not adversely impact agriculture.

IT WAS

MOVED BY: Commissioner Purdy

SECONDED BY: Commissioner Mayer

THAT the application be allowed.

This decision does not relieve the owner or occupier of the responsibility to comply with applicable Acts, regulations, bylaws of the local government, and decisions and orders of any person or body having jurisdiction over the land under an enactment.

CARRIED

Resolution # 16/2009

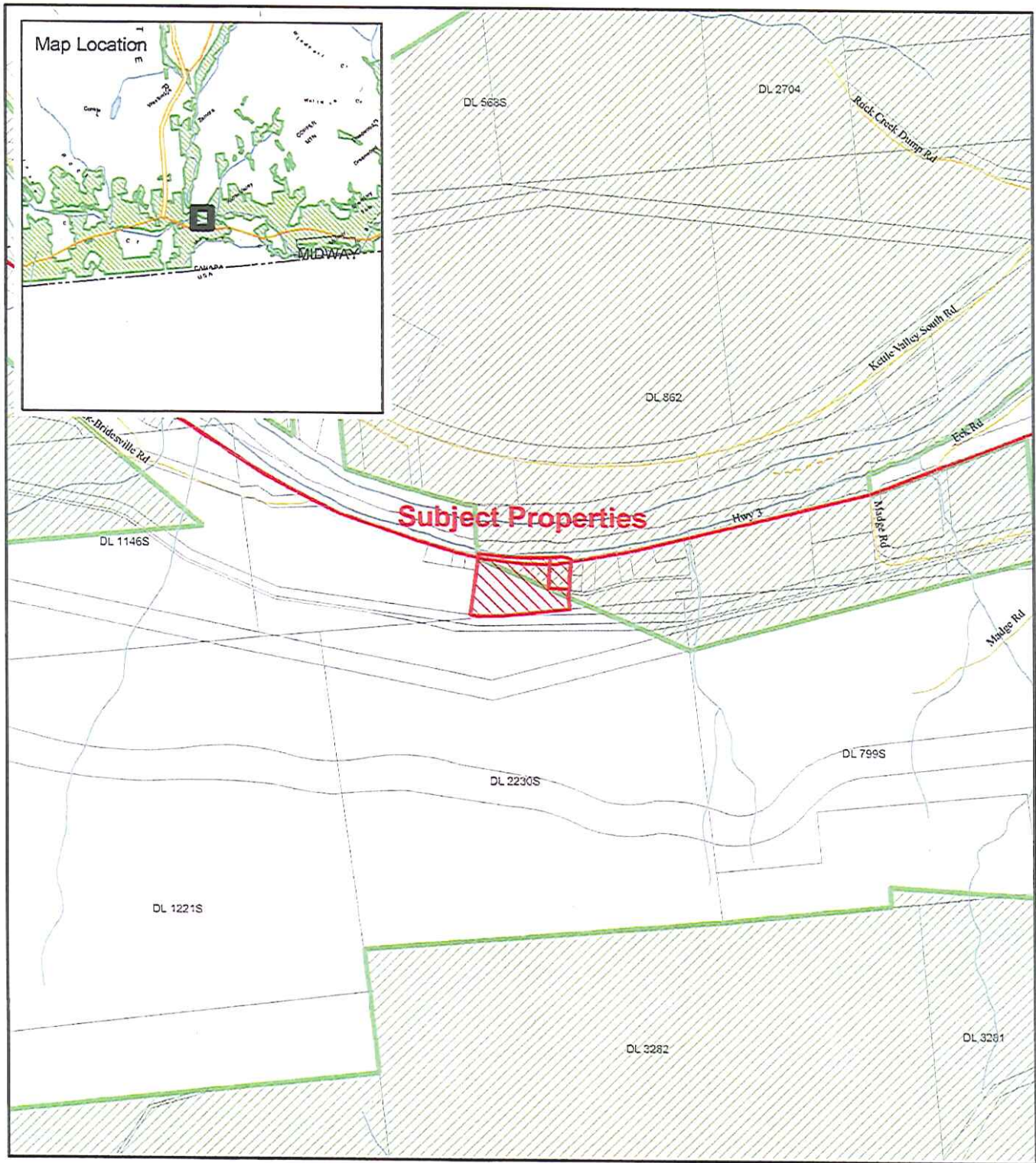

Context Map
 Map Scale: 1:10,000

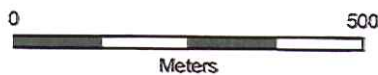

ALC File #:	02-08-38685
Mapsheet #:	82E.006
Map Produced:	Dec 3, 2008
Regional District:	Kootenay-Boundary