



**Agricultural Land Commission**  
133-4940 Canada Way  
Burnaby, British Columbia V5G 4K6  
Tel: 604 660-7000  
Fax: 604 660-7033  
www.alc.gov.bc.ca

January 9, 2009

Reply to the attention of Terra Kaethler  
ALC File: C-38401

Corporation of the District of Central Saanich  
1903 Mount Newton Cross Road  
Saanichton, BC V8M2A9

Dear Sir/Madam:

**Re: Application for Transportation Corridor the Agricultural Land Reserve**

Please find attached the Minutes of Resolution # 717/2008 outlining the Commission's decision as it relates to the above noted application.

Yours truly,

PROVINCIAL AGRICULTURAL LAND COMMISSION

Per:

A handwritten signature in black ink, appearing to read 'Erik Karlsen', written over a white background.

Erik Karlsen, Chair

Enclosure: Minutes/Sketch Plan

cc: The Corporation of the District of Central Saanich (5486)  
Thomas and Katarina Gallagher - 6924 West Saanich Road, Brentwood Bay, BC,  
V8M1G8;

TK/  
i/38401.d1



### **Context**

The proposal was weighed against the purposes of the Commission as stipulated in section 6 of the *Agricultural Land Commission Act* (the "Act"). They are:

1. to preserve agricultural land
2. to encourage farming on agricultural land in collaboration with other communities of interest, and
3. to encourage local governments, first nations, the government and its agents to enable and accommodate farm use of agricultural land and uses compatible with agriculture in their plans, bylaws and policies.

### **Discussion**

The Commission assessed the impact of the proposal against the long term goal of preserving agricultural land. The Commission considered that the right of way was already in existence and that the proposal was to construct a gravel surface road within the right of way and legalize the access road to the property. The Commission discussed the three options presented and believed that Option 1, which proposed access from West Saanich road to a maximum distance of 90 meters, would have the least impact on agriculture and therefore would be the most suitable option. Therefore, the Commission believed that providing legal access to the subject property would have no negative impact to the agricultural use of the property or surrounding lands.

As to the request that the recreational trail be accommodated, the Commission considered that the right of way is already used as a trail, but that it is not maintained by the District of Central Saanich and is only available on a seasonal basis. The Commission had no objection to the continued use of the right of way as a recreational trail.

Therefore, the Commission did not believe the proposal would impact existing or potential agricultural use of surrounding lands.

### **Conclusion**

That the access road proposed in Option 1 will not negatively impact agriculture.

#### **IT WAS**

**MOVED BY:** Commissioner Craven

**SECONDED BY:** Commissioner Dyson

THAT the proposed access road from West Saanich Road to a maximum distance of 90 meters be approved.

This decision does not relieve the owner or occupier of the responsibility to comply with applicable Acts, regulations, bylaws of the local government, and decisions and orders of any person or body having jurisdiction over the land under an enactment.

#### **CARRIED**

**Resolution # 717/2008**

Provincial Agricultural Land Commission  
Application # 38401  
Resolution #717/2008

Approved for construction of Right of Way

Appendix 'B'

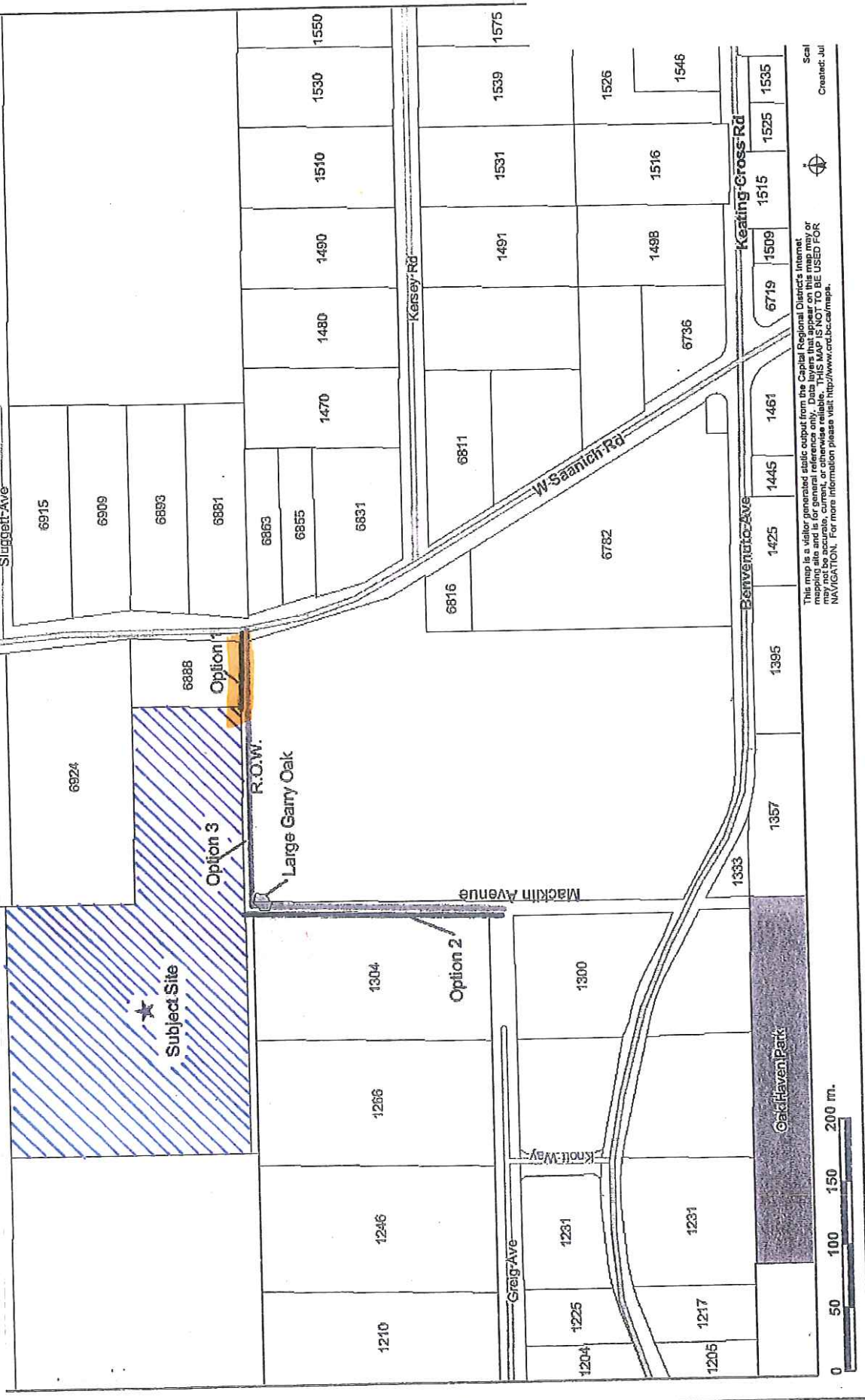

This map is a vector generated static output from the Capital Regional District's Internet mapping site and is for general reference only. Data layers are not to be used for NAVIGATION. For more information please visit <http://www.crd.bc.ca/maps>.  
Scale Created: Jul