



Agricultural Land Commission
133-4940 Canada Way
Burnaby, British Columbia V5G 4K6
Tel: 604 660-7000
Fax: 604 660-7033
www.alc.gov.bc.ca

December 1, 2008

Reply to the attention of Brandy Ridout
ALC File: **V-38595**

Greg Norton
RR5 - 37070 - 149th Street
Oliver, BC V0H1T0

Dear Mr. Norton:

Re: Application to Include Land into the Agricultural Land Reserve

Please find attached the Minutes of Resolution #744/2008 outlining the Commission's decision as it relates to the above noted application. As agent, it is your responsibility to notify your client accordingly.

Yours truly,

PROVINCIAL AGRICULTURAL LAND COMMISSION

Per:

A handwritten signature in black ink, appearing to read 'Erik Karlsen', is written over the printed name below.

Erik Karlsen, Chair

Enclosure: Minutes/Sketch Plan

cc: Regional District of Okanagan-Similkameen (C08-07072-000)

BR/
i/38595d1

Discussion

Assessment of Agricultural Capability

The agricultural capability of the soil of the portion of the subject property proposed for subdivision is 70% Class 6T and 30% Class 7RT. Despite the poor agricultural capability ratings of the area, it was indicated by the applicant that there are portions that are suitable for grape production.

Classes:

Class 6 – Land in this class is non-arable but is capable of producing native and or uncultivated perennial forage crops.

Class 7 – Land in this class has no capability for arable or sustained natural grazing

Subclasses:

R shallow soil / bedrock outcroppings

T topography

Assessment of Impact on Agriculture

During its review of application #V-38128, the Commission noted that land that was to be put into agricultural production should be included into the ALR. As such it required that the non-ALR component of the proposed 24.6 ha lot be included into the ALR. The current application proposes to include the required 16.2 ha area.

Conclusion

That the 16.2 ha area proposed for inclusion has some agricultural capability, will be put into grape production, and would appropriately be included into the ALR.

IT WAS

MOVED BY: Commissioner Sidhu

SECONDED BY: Commissioner Mayer

THAT the application to include approximately 16.2 ha into the Agricultural Land Reserve to satisfy a condition of approval under Resolution #435/2008 (application #V-38128) be approved.

This decision does not relieve the owner or occupier of the responsibility to comply with applicable Acts, regulations, bylaws of the local government, and decisions and orders of any person or body having jurisdiction over the land under an enactment.

CARRIED

Resolution #744/2008

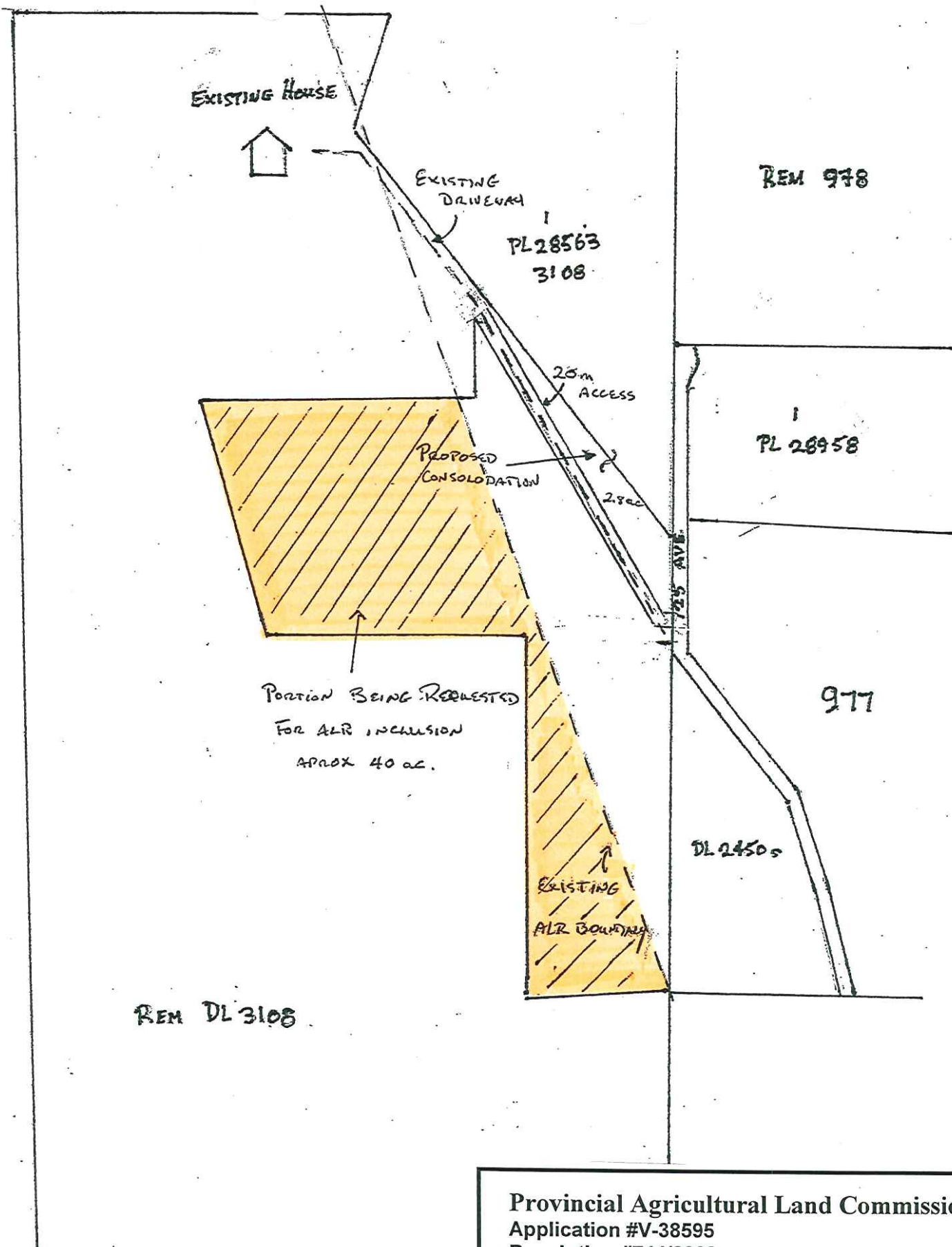

Provincial Agricultural Land Commission
 Application #V-38595
 Resolution #744/2008

 16.2 ha area approved for inclusion into the ALR