



**Agricultural Land Commission**  
133-4940 Canada Way  
Burnaby, British Columbia V5G 4K6  
Tel: 604 660-7000  
Fax: 604 660-7033  
www.alc.gov.bc.ca

October 29, 2008

Reply to the attention of Simone Rivers  
ALC File: W-38569

Jason and Teresa Bodo  
Box 181 - 5547 Highway 29 South  
Chetwynd, BC V0C1J0

Dear Mr. and Mrs. Bodo:

**Re: Application to Include land in the Agricultural Land Reserve**

Please find attached the Minutes of Resolution # 688/2008 outlining the Commission's decision as it relates to the above noted application.

Please be advised that this fulfills the remaining condition of Resolution # 319/2007. As you have already provided us with your final survey plans we write to inform that an authorization letter will be sent to the Land Titles Office authorizing deposit of the plans. You will receive a copy of the letter in due course.

Yours truly,

PROVINCIAL AGRICULTURAL LAND COMMISSION

Per:

A handwritten signature in black ink that reads "Simone Rivers". The signature is written in a cursive, flowing style.

Erik Karlsen, Chair

Enclosure: Minutes/Sketch Plan

cc: Peace River Regional District (202/2008)  
BC Assessment, Dawson Creek

SBR/  
i/38569d1



iMapBC Mapping

Legend

ROAD Digital Road Atlas - Partly Aired

Water - Rivers, Creeks, and Streams (1:50,000)

Boundary of Public or unincorporated

Boundary of Public or unincorporated

Plains or 1/4 section (1/4) Block

Plains or 1/4 section (1/4) Block

Plains or 1/4 section (1/4) Block

Plains or 1/4 section (1/4) Block

Plains or 1/4 section (1/4) Block

Plains or 1/4 section (1/4) Block

Plains or 1/4 section (1/4) Block

Plains or 1/4 section (1/4) Block

Plains or 1/4 section (1/4) Block

Plains or 1/4 section (1/4) Block

Plains or 1/4 section (1/4) Block

Plains or 1/4 section (1/4) Block

Plains or 1/4 section (1/4) Block

Plains or 1/4 section (1/4) Block

Plains or 1/4 section (1/4) Block

Plains or 1/4 section (1/4) Block

Plains or 1/4 section (1/4) Block

Plains or 1/4 section (1/4) Block

Plains or 1/4 section (1/4) Block

Plains or 1/4 section (1/4) Block

Plains or 1/4 section (1/4) Block

Plains or 1/4 section (1/4) Block

Plains or 1/4 section (1/4) Block

Plains or 1/4 section (1/4) Block

Plains or 1/4 section (1/4) Block

Plains or 1/4 section (1/4) Block

Plains or 1/4 section (1/4) Block

Plains or 1/4 section (1/4) Block

Plains or 1/4 section (1/4) Block

Plains or 1/4 section (1/4) Block

Plains or 1/4 section (1/4) Block

Plains or 1/4 section (1/4) Block

Plains or 1/4 section (1/4) Block

0

150 m.

Scale: 1:50,000

Copyright/Disclaimer

The material contained in this web site is owned by the Government of British Columbia and protected by copyright law. All rights are reserved. No part of this material may be reproduced, stored in a retrieval system, or transmitted in any form or by any means, electronic, mechanical, photocopying, recording, or by any information storage and retrieval system, without the prior written permission of the Province of British Columbia. To request permission to reproduce this material, please contact the Copyright Clearance Center, Inc., 222 Rosewood Drive, Danvers, MA 01923, USA. For more information, please visit the Copyright Clearance Center website at www.copyright.com. This material may be accessed through the Copyright Clearance Center website at www.copyright.com. This material may be accessed through the Copyright Clearance Center website at www.copyright.com.

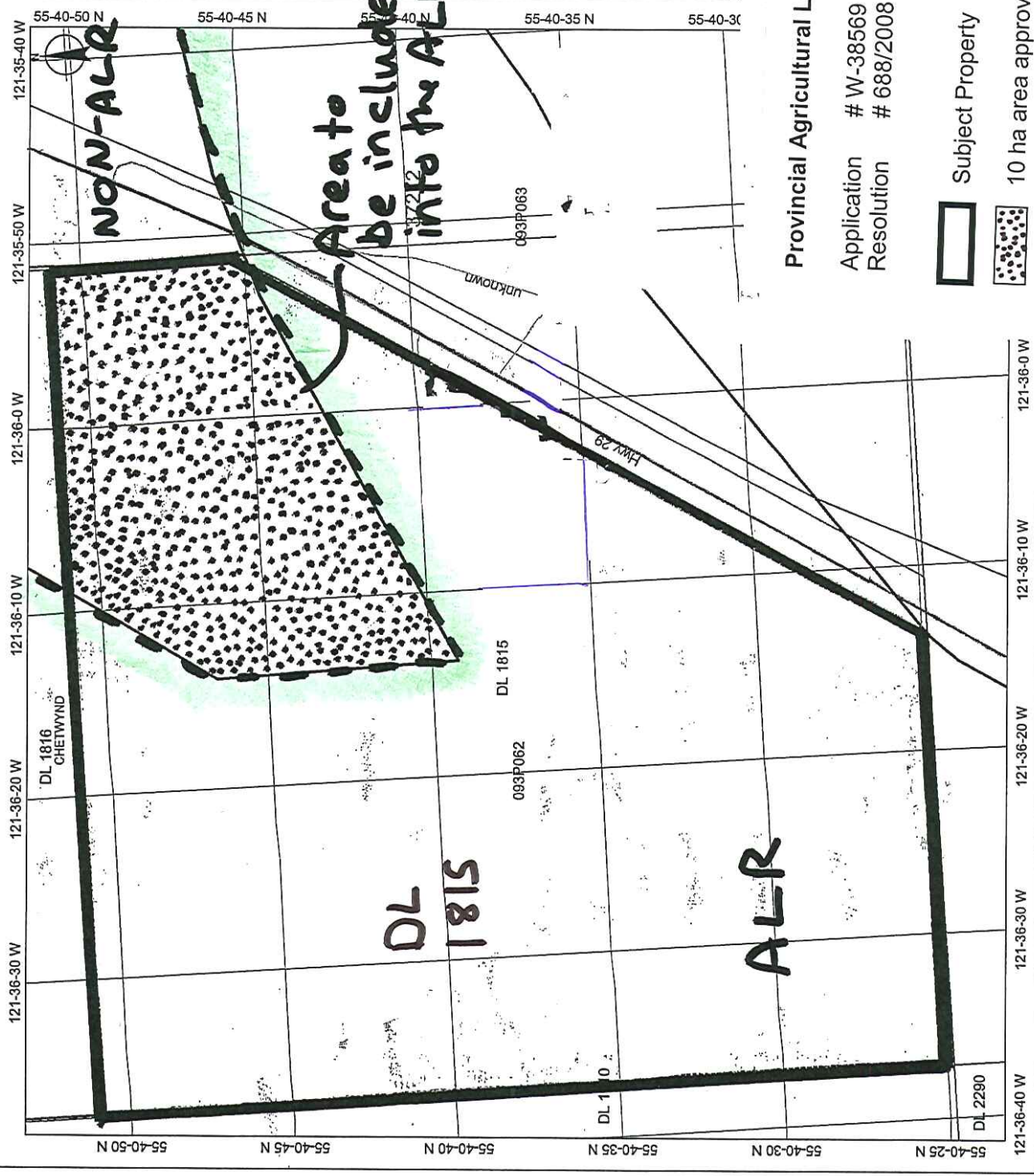

### Provincial Agricultural Land Commission

Application # W-38569  
Resolution # 688/2008

Subject Property

10 ha area approved for inclusion into the ALR

