



Agricultural Land Commission
133-4940 Canada Way
Burnaby, British Columbia V5G 4K6
Tel: 604 660-7000
Fax: 604 660-7033
www.alc.gov.bc.ca

July 7, 2008

Reply to the attention of Simone Rivers
ALC File: W-38186

Crystal Springs Ranch Inc.
PO Box 276
Charlie Lake, BC V0C1H0

Dear Sir/Madam:

Re: Application for Transportation Corridor the Agricultural Land Reserve

Please find attached the Minutes of Resolution # 363/2008 outlining the Commission's decision as it relates to the above noted application.

Yours truly,

PROVINCIAL AGRICULTURAL LAND COMMISSION

Per:



Erik Karlsen, Chair

cc: Peace River Regional District

Enclosure: Minutes/Sketch Plan

SBR/
i/38186d1

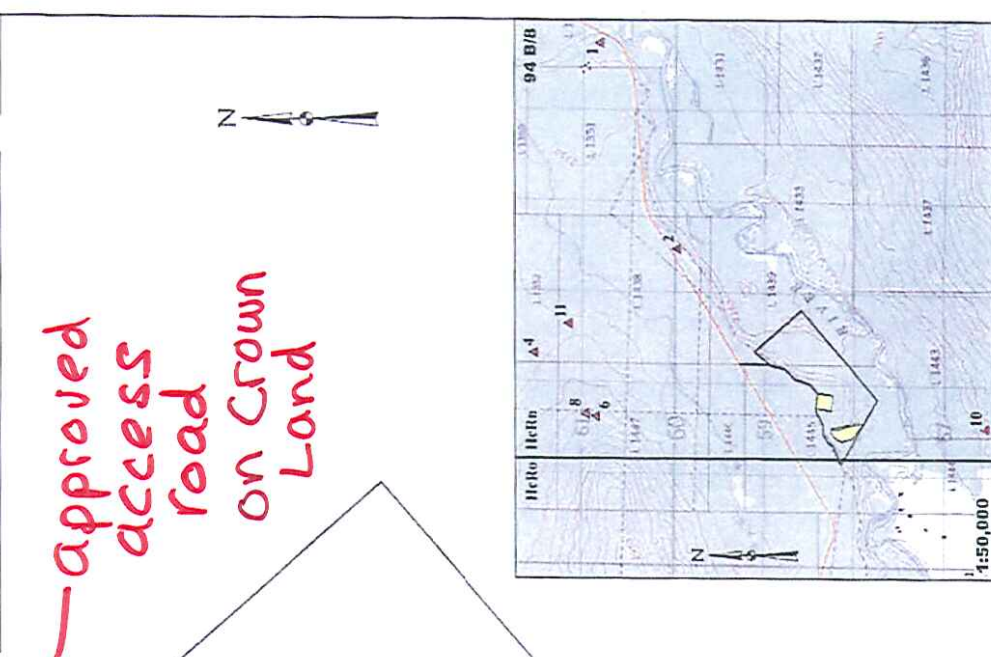
Project Component		Dimensions (m)
Gravel Pit 'A'		3.8 Ha
Gravel Pit 'B'		11.6c
Access Road		10



Approved access road on Crown Land

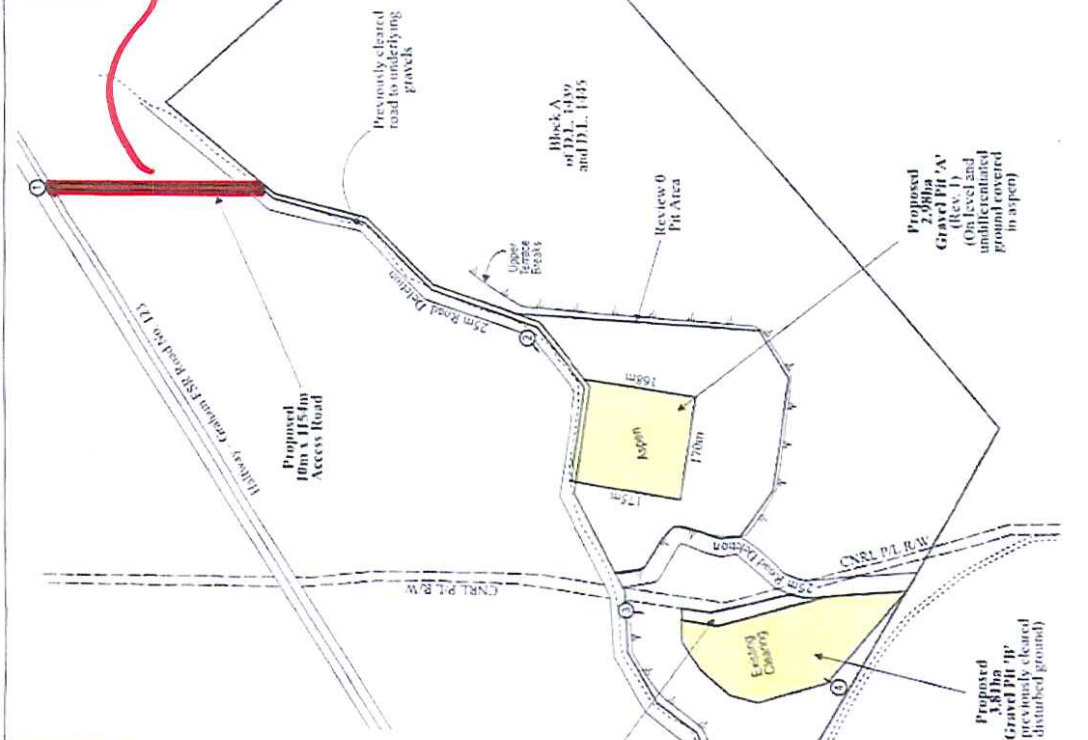

ARCHAEOLOGICAL ASSESSMENT	
Permit Application	Cystal Springs Ranch, Inc.
Crystal Springs Gravel Pits within Units 66 & 67, Block K, 94-B-8	
HERITAGE NORTH CONSULTING LIMITED 6912 107 th Street Fort St. John, BC V1J 6H1 Tel: (250) 354-0114 Fax: (250) 385-0972	
LEGEND Project Area - □	
Date: Nov. 20, 2007	Scale: 1:500
Drawn by: CLW	Revision: 0
	Block File

**Application # W-38186
Resolution # 363/2008**



MINUTES OF THE PROVINCIAL AGRICULTURAL LAND COMMISSION

A meeting was held by the Provincial Agricultural Land Commission on June 19, 2008 at the offices of the Peace River Regional District, Dawson Creek.

PRESENT:	William Norton	Chair, North Panel
	Denise Dowswell	Commissioner
	John Kendrew	Commissioner
	Simone Rivers	Staff

For Consideration

Application: # W- 38186
Applicant: Crystal Springs Ranch Inc.
Proposal: To construct an access road through Crown Land to access a proposed Gravel Pit within the ALR
Legal: Crown land described as: "Remainder, District Lot 1439" in the vicinity of:
PID: 019-085-681
District Lot 1439 and 1445, Block A, Peace River District
Location: West of Fort St. John along the Graham River on the Halfway Road

Site Inspection

A site inspection was not conducted.

Discussion

The Commission had no objection to the construction of the proposed access road across Crown Land as the road was being built to access a gravel pit located on the applicant's private land. The CEO had set terms and conditions for the operation of the gravel pit as per their authority under the Agricultural Land Commission Act.

IT WAS

MOVED BY: Commissioner Kendrew
SECONDED BY: Commissioner Dowswell

THAT the application be allowed.

AND THAT the approval is subject to the acceptance and compliance by the applicant with the terms and conditions for aggregate extraction as outlined in file # **W-36121** – **Notice of Intent to extract aggregate in an ALR.**

This decision does not relieve the owner or occupier of the responsibility to comply with applicable Acts, regulations, bylaws of the local government, and decisions and orders of any person or body having jurisdiction over the land under an enactment.

CARRIED

Resolution # 363/2008