



Agricultural Land Commission
133-4940 Canada Way
Burnaby, British Columbia V5G 4K6
Tel: 604 660-7000
Fax: 604 660-7033
www.alc.gov.bc.ca

May 16, 2008

Reply to the attention of Simone Rivers
ALC File: D-38028

Robert and Sharon Godfrey
Box 211
Horsefly, BC V0L1L0

Dear Mr. and Mrs. Godfrey:

Re: Application to Subdivide land in the Agricultural Land Reserve

Please find attached the Minutes of Resolution # 204/2008 outlining the Commission's decision as it relates to the above noted application.

Please send two (2) paper prints of the final survey plans to this office. When the Commission confirms that all conditions have been met, it will authorize the Registrar of Land Titles to accept registration of the plan.

Yours truly,

PROVINCIAL AGRICULTURAL LAND COMMISSION

Per:

A handwritten signature in black ink that reads "Erik Karlsen". The signature is written in a cursive, flowing style.

Erik Karlsen, Chair

cc: Cariboo Regional District (4035-20-F240)

Enclosure: Minutes/Sketch Plan

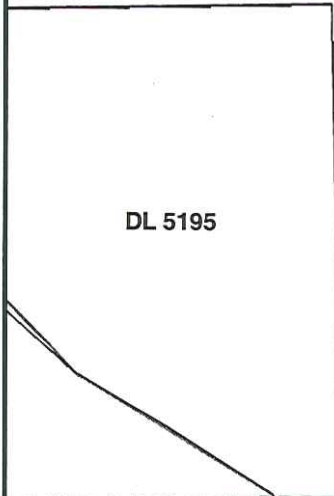
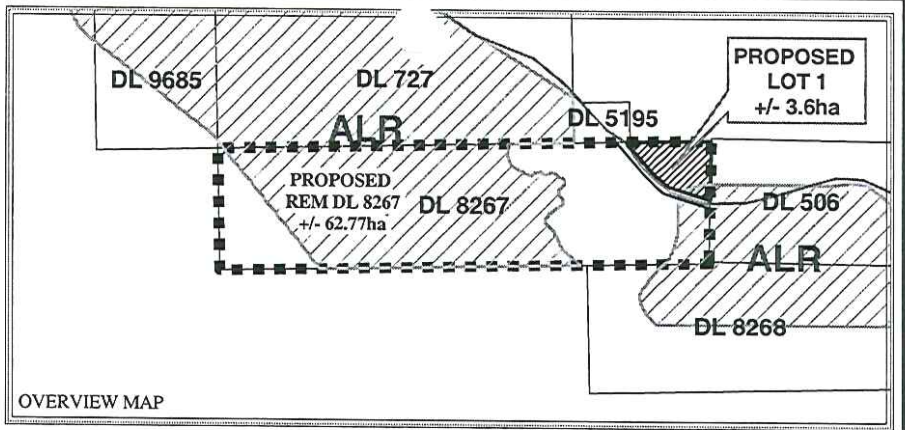

UNSURVEYED CROWN LAND

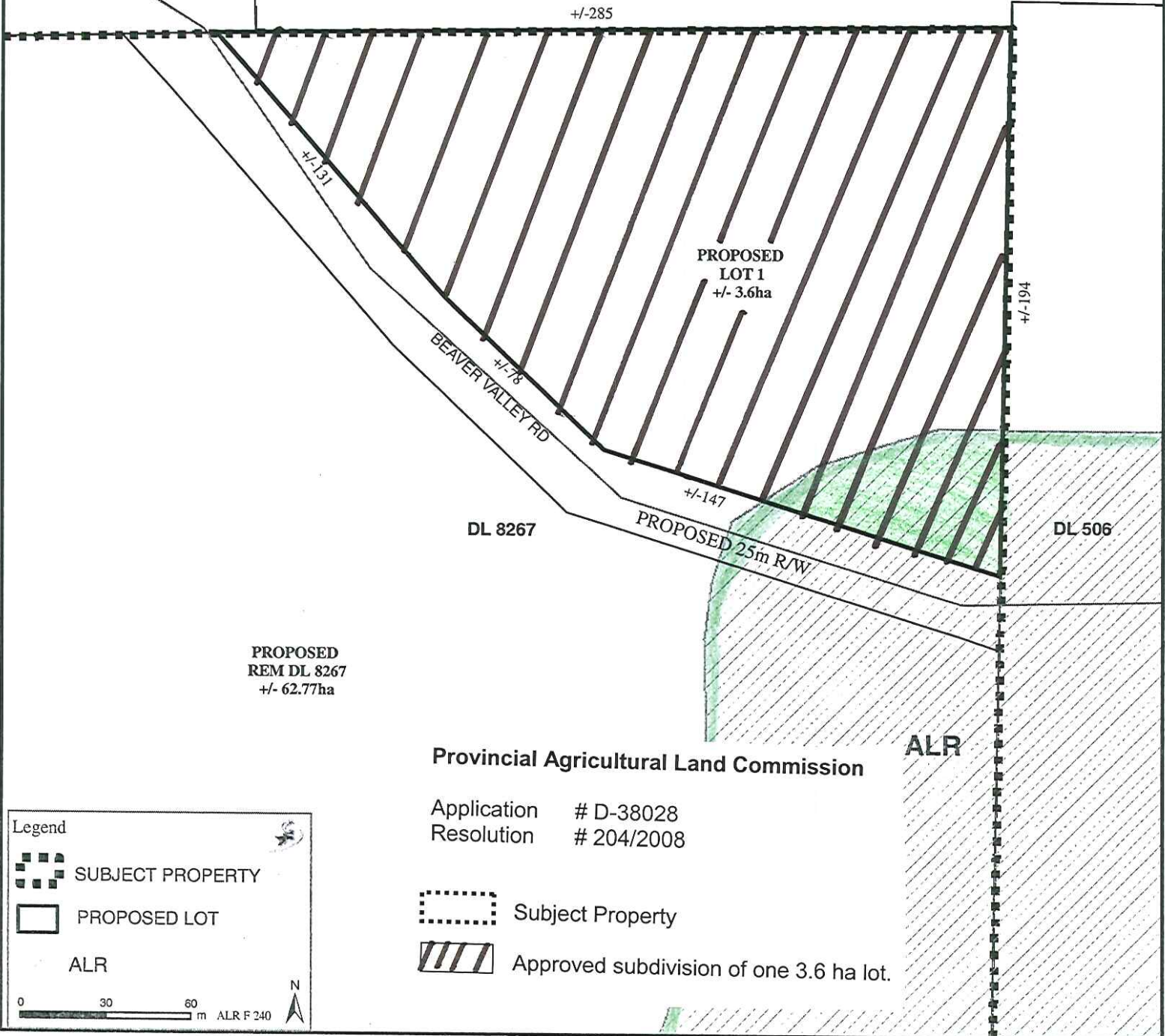



MINUTES OF THE PROVINCIAL AGRICULTURAL LAND COMMISSION

A meeting was held by the Provincial Agricultural Land Commission on April 30, 2008 at the offices of the Ministry of Agriculture and Lands, Kamloops B.C.

PRESENT: Grant Huffman
Holly Campbell
Gordon Gillette
Simone Rivers

Chair, Interior Panel
Commissioner
Commissioner
Staff

For Consideration

Application: # D- 38028
Applicant: Robert and Sharon Godfrey
Proposal: To subdivide the 66.37 ha subject property to create one (1) +/-3.5 ha lot from the parent property as delineated by Beaver Valley Road.
Legal: PID: 015-384-764
District Lot 8267, Cariboo District
Location: Located 12km north-west of Horsefly at 4920 Beaver Valley Road

Site Inspection

A site inspection was not conducted.

Discussion

The Commission had no objection to the proposed subdivision as only 0.3 ha of the proposed 3.6 ha lot was in the ALR. As the proposed lot was divided from the remainder of the property by an existing road the Commission believed that there would be no benefit to agriculture to requiring the ALR portion of the property to be tied to the remainder on the other side of the road.

IT WAS

MOVED BY: Commissioner Huffman
SECONDED BY: Commissioner Campbell

THAT the application be allowed.

AND THAT the approval is subject to the following conditions:

- the subdivision be in substantial compliance with the plan submitted with the application
- the subdivision must be completed within three (3) years from the date of this decision.

This decision does not relieve the owner or occupier of the responsibility to comply with applicable Acts, regulations, bylaws of the local government, and decisions and orders of any person or body having jurisdiction over the land under an enactment.

CARRIED

Resolution # 204/2008