



**Agricultural Land Commission**  
133-4940 Canada Way  
Burnaby, British Columbia V5G 4K6  
Tel: 604 660-7000  
Fax: 604 660-7033  
www.alc.gov.bc.ca

December 18, 2007

Reply to the attention of Martin Collins  
ALC File: V-37756

Tony Lee, Manager, Acquisitions and Projects  
BC Hydro & Power Authority  
8th Floor - 333 Dunsmuir Street  
Vancouver, BC  
V6B5R3

Dear Sir:

**Re: Application for Subdivision and Non Farm uses in the Agricultural Land Reserve**

Please find attached the Minutes of Resolution # 662/2007 outlining the Commission's decision as it relates to the above noted application. Attached is a copy of the plan showing the approved subdivision and non farm use.

Please send two (2) paper prints of the final survey plans to this office. When the Commission confirms that all conditions have been met, it will authorize the Registrar of Land Titles to accept registration of the plan.

Yours truly,

PROVINCIAL AGRICULTURAL LAND COMMISSION

Per:

A handwritten signature in black ink, appearing to read 'Erik Karlsen', written over a horizontal line.

Erik Karlsen, Chair

cc: Regional District of Okanagan-Similkameen

Enclosure: Minutes/Sketch Plan



## **Discussion**

### **Assessment of Agricultural Capability and Suitability**

In assessing agricultural capability, the Commission confirmed that the land under application has challenges to agricultural development because of poor soils, high elevation and rough topography. Intermittent rough grazing is the primary land use in the ALR in this area.

### **Assessment of Impact on Agriculture**

The Commission also assessed the impact of the proposal against the long term goal of preserving agricultural land, noting that the majority of the 6.4 ha parcel would remain available for grazing. Only about 2 ha would contain the capacitor facility (which would be fenced).

### **Conclusions**

1. That the land under application has very limited agricultural capability
2. That the land under application is suitable for rough grazing.
3. That the subdivision and non farm proposal will not substantively affect agriculture.

### **IT WAS**

**MOVED BY:** Commissioner R. Mayer

**SECONDED BY:** Commissioner S. Sidhu

THAT the application to subdivide a 6.4 ha lot from the 130 ha property, and construct a capacitor station be allowed.

AND THAT the approval is subject the statutory right of way be in substantial compliance with the plan submitted with the application.

This decision does not relieve the owner or occupier of the responsibility to comply with applicable Acts, regulations, bylaws of the local government, and decisions and orders of any person or body having jurisdiction over the land under an enactment.

### **CARRIED**

**Resolution # 662/2007**

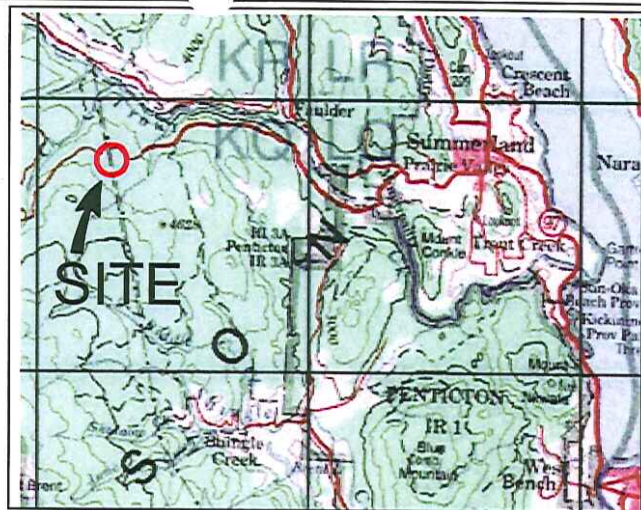
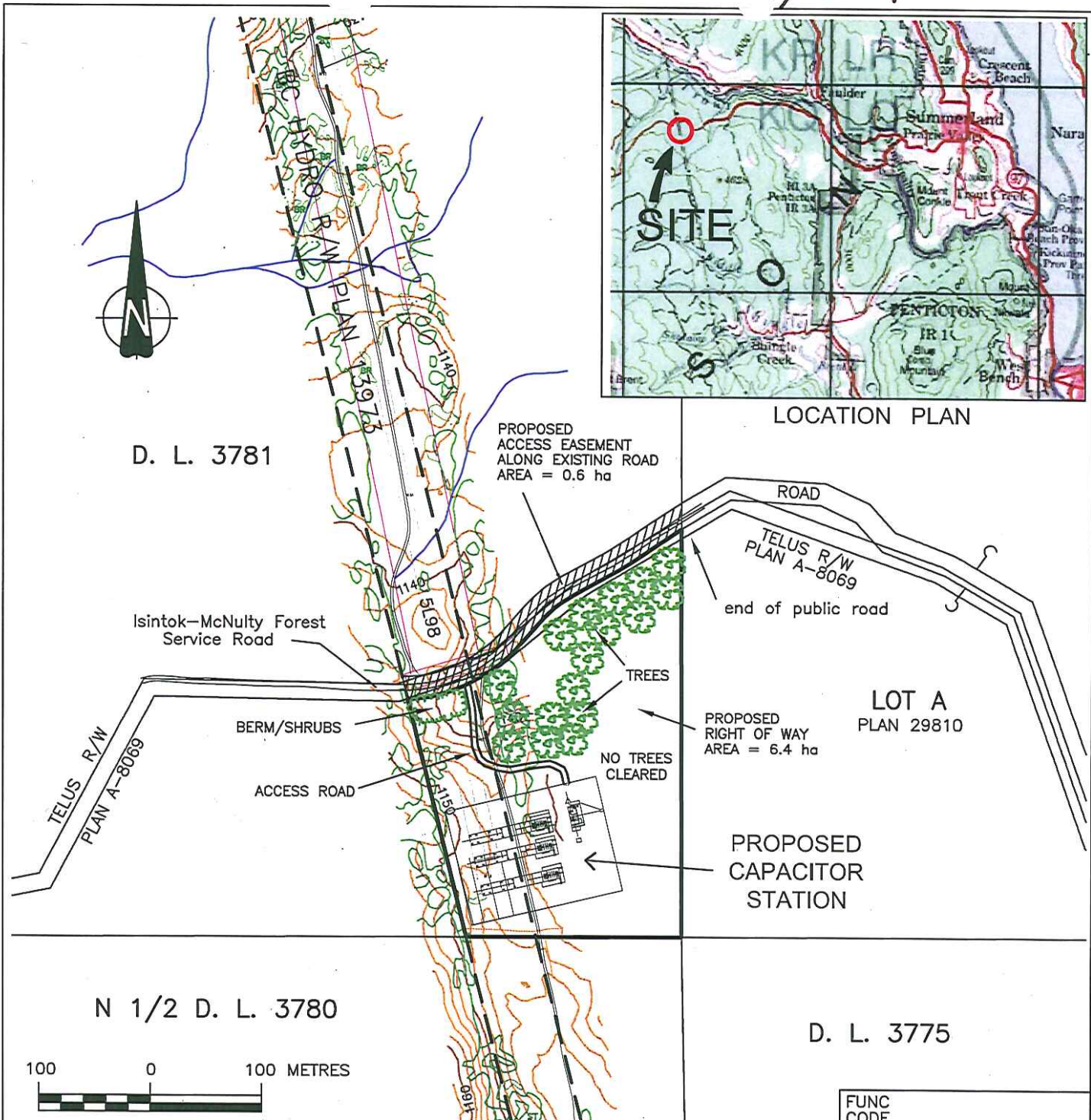

LOCATION PLAN

DSGN	
INDEP CHK	
DFTG	WALKER, IAN
DFTG CHK	
INSP	
REV	LAST MODIFIED DATE 2007-9-10
CREATE DATE	2007-9-7

**BChydro** **ENGINEERING**

TRANSMISSION DIVISION SURVEY SERVICES

Summerland  
Trout Creek Capacitor Station  
Preliminary Site Plan

DWG NO	5L98_TROUT_CK_CAPACITOR.DWG	R 0
CAD		