



Agricultural Land Commission
133-4940 Canada Way
Burnaby, British Columbia V5G 4K6
Tel: 604 660-7000
Fax: 604 660-7033
www.alc.gov.bc.ca

December 18, 2007

Reply to the attention of Martin Collins
ALC File: V-37653

Tim Hall
Box 2080
Princeton, BC V0X1W0

Dear Sir:

Re: Application to Subdivide Land within the Agricultural Land Reserve

Please find attached the Minutes of Resolution # 660/2007 outlining the Commission's decision as it relates to the above noted application. A map depicting the Commission's decision is also attached. As agent, it is your responsibility to notify your client(s) accordingly.

Please send two (2) paper prints of the final survey plans to this office. When the Commission confirms that the plan is consistent with its decision, it will authorize the Registrar of Land Titles to accept registration of the plan.

Yours truly,

PROVINCIAL AGRICULTURAL LAND COMMISSION

Per:

A handwritten signature in black ink, appearing to read 'Erik Karlsen', written over a white background.

Erik Karlsen, Chair

cc: Regional District of Okanagan-Similkameen (H-07-00825-000)

Enclosure: Minutes/Sketch Plan

Assessment of Impact on Agriculture

The Commission also assessed the impact of the proposal against the long term goal of preserving agricultural land. The Commission did not believe the proposal would affect existing or potential agricultural uses of surrounding lands.

Conclusions

1. That the land under application has very limited agricultural capability and lies largely outside the ALR.
2. That the majority of the land under application is not suitable for agricultural use.
3. That the proposal will not affect agriculture.

IT WAS

MOVED BY: Commissioner R. Mayer

SECONDED BY: Commissioner S. Irvine

THAT the application to subdivide a 10 ha and 15 ha lot from the 125 ha property as divided by the Princeton/Summerland Road be allowed.

AND THAT the approval is subject to the subdivision being completed within three (3) years of the date of this decision.

This decision does not relieve the owner or occupier of the responsibility to comply with applicable Acts, regulations, bylaws of the local government, and decisions and orders of any person or body having jurisdiction over the land under an enactment.

CARRIED

Resolution # 660/2007

PLAN SHOWING PROPOSED SUBDIVISION C - PART OF

DISTRICT LOT 935, K.D.Y.D.

Scale 1: 10,000

Dated 24th April 2007

ZONING RA.

△ Denotes 4ft picket set.

ALC APPLICATION
V-37653
RES # 660/2007

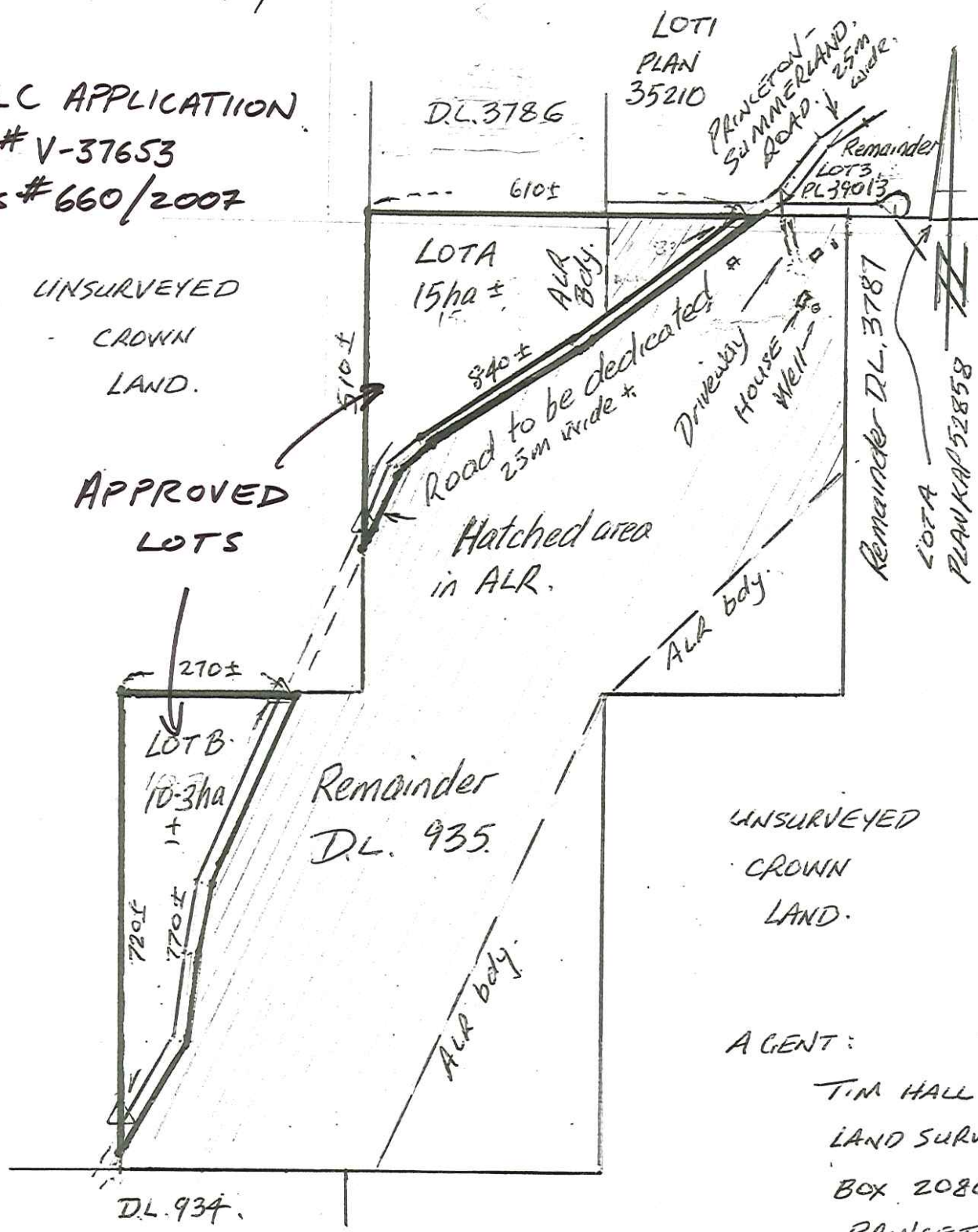

AGENT:
TIM HALL
LAND SURVEYOR
BOX 2080
PRINCETON BC
VOK 120.

Owner: Merlin Monica Hersey
4095 Skyline Dr. Nth Vancouver BC V7R 3G7
Ph 245 3938 or (604) 980 8628.

Ph/Fax (250) 295 6761
JOB N° 2562