



Agricultural Land Commission
133-4940 Canada Way
Burnaby, British Columbia V5G 4K6
Tel: 604-660-7000
Fax: 604-660-7033
www.alc.gov.bc.ca

March 1, 2007

Reply to the attention of Simone Rivers
ALC File: #N - 37094

Integrated Land Management Bureau
200 - 1488 - 4th Avenue,
Prince George, BC V2L 4Y2

Dear Sir/Madam:

Re: Application to Include land into the Agricultural Land Reserve
Your File: #7408387

Please find attached the Minutes of Resolution # 37/2007 outlining the Commission's decision as it relates to the above noted application. As agent, it is your responsibility to notify your client(s) accordingly.

It is our understanding that the Integrated Land Management Bureau will inform the Registrar of Land Titles of the ALR status of the property when the title is transferred.

Yours truly,

PROVINCIAL AGRICULTURAL LAND COMMISSION

Per:

A handwritten signature in black ink, appearing to read 'Erik Karlsen', is written over the 'Per:' label. The signature is fluid and cursive.

Erik Karlsen, Chair

cc: Regional District of Fraser-Fort George (#ALR2244/2245)

Enclosure: Minutes/Sketch Plan

SBR/iv
37094d1

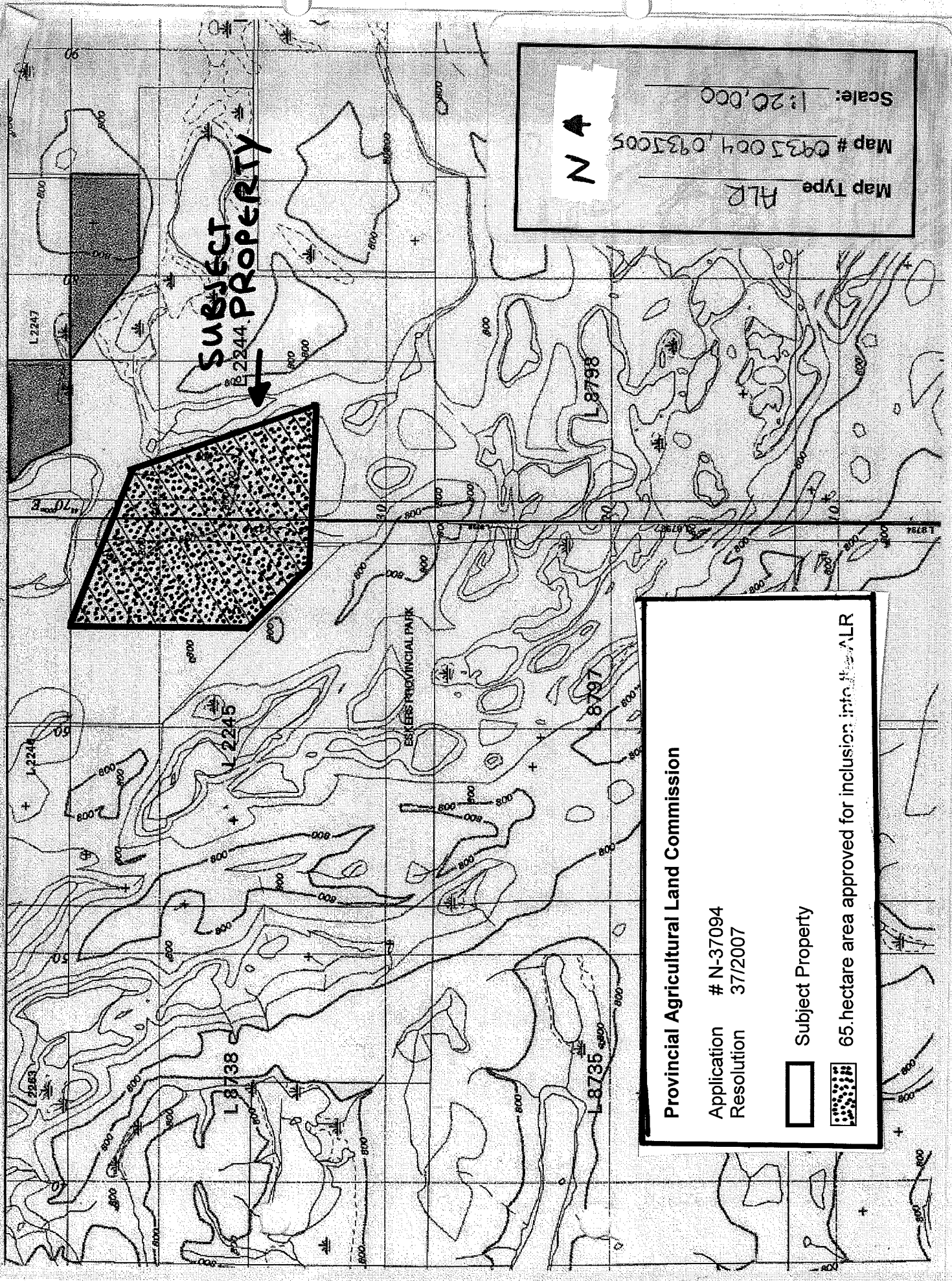

Map Type ALR
 Map # 0935004, 0935005
 Scale: 1:20,000

Provincial Agricultural Land Commission

Application # N-37094
 Resolution 37/2007

Subject Property
 65 hectare area approved for inclusion into the ALR



MINUTES OF THE PROVINCIAL AGRICULTURAL LAND COMMISSION

A meeting was held by the Provincial Agricultural Land Commission on February 21, 2007 at Dawson Creek, BC.

PRESENT:	Frank Read	Chair, North Panel
	John Kendrew	Commissioner
	William Norton	Commissioner
	Martin Collins	Staff
	Brian Underhill	Staff

For Consideration

Application: # N- 37094
Applicant: Lora Lee Austin
Agent: Integrated Land Management Bureau
Proposal: To include 65 ha of Crown Land into the Agricultural Land Reserve.
Legal: Part of District Lot 2244 and 2245, Cariboo District
Location: Located near Hidden Lake next to Eskers Provincial Park, Prince George

Site Inspection

A site inspection was not conducted.

Discussion

The Commission had no objection to the proposed inclusion on the grounds that the land is being Crown granted for agricultural purposes and the application is consistent with the long-standing Memorandum of Understanding (MOU) between the Commission and the Integrated Land Management Bureau (ILMB) and its predecessors.

Conclusions

1. That the land under application has agricultural capability and is appropriately designated as ALR.
2. That the land under application is suitable for agricultural use.

IT WAS

MOVED BY: Commissioner Kendrew

SECONDED BY: Commissioner Norton

THAT the application be allowed.

This decision does not relieve the owner or occupier of the responsibility to comply with applicable Acts, regulations, bylaws of the local government, and decisions and orders of any person or body having jurisdiction over the land under an enactment.

CARRIED

Resolution # 37/2007



Staff Report
Application # N – 37094
Applicant: Lora Lee Austin
Agent: Integrated Land Management Bureau

DATE RECEIVED: December 6, 2006

DATE PREPARED: January 5, 2007

TO: Chair and Commissioners – North Panel

FROM: Simone Rivers, Land Use Planner

PROPOSAL: To include 65 ha of Crown Land into the Agricultural Land Reserve.

This application is made pursuant to section 17(3) of the *Agricultural Land Commission Act*.

BACKGROUND INFORMATION:

Local Government:

Regional District of Fraser-Fort George

Legal Description of Property:

Part of District Lot 2244 and 2245, Cariboo District

Location of Property:

Located near Hidden Lake next to Eskers Provincial Park, Prince George

Size of Property:

65.0 ha (The entire property is in the ALR).

Present use of the Property:

Undeveloped Crown Land

Surrounding Land Uses:

WEST: Eskers Provincial Park - undeveloped

SOUTH: Undeveloped Crown Land

EAST: Undeveloped Crown Land

NORTH: Undeveloped Crown Land and Hidden Lake

Agricultural Capability:

Data Source: Agricultural Capability Map # 93J/3
The majority of the property is identified as having Secondary ratings.

Official Community Plan and Designation:

Salmon River-Lakes OCP, Bylaw No. 1587
Designation: Agriculture/Resource (Ag/Res)

Zoning Bylaw and Designation:

Zoning: Bylaw No. 833
Designation: Rural 3 (Ru3)
Minimum Lot Size: 60 ha

LOCAL GOVERNMENT RECOMMENDATIONS/COMMENTS:

Fraser-Fort George Regional District Board: The Regional Board forwarded the application with a recommendation of approval based on the arability of the Land

STAFF COMMENTS:

The arability map submitted by the Integrated Land Management Bureau indicates that 100% of the subject property is arable with the majority of class 4 soils as well as some class 5. Climate and topography are the major limitations.

ATTACHMENTS:

- Airphoto - 1:20,000 (created by ALC Staff)
- Location Context Map (1:150,000) (created in iMap by ALC Staff)

END OF REPORT

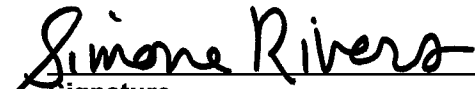

Signature

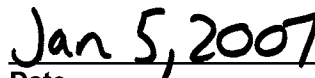

Date