



Agricultural Land Commission
133-4940 Canada Way
Burnaby, British Columbia V5G 4K6
Tel: 604-660-7000
Fax: 604-660-7033
www.alc.gov.bc.ca

November 30, 2006

Reply to the attention of Simone Rivers
ALC File: ZZ - 36904

Civic Engineering Services Ltd.
293 First Avenue
Kamloops, BC V2C 3J3

Dear Sir/Madam:

Re: Application for Utility Corridor the Agricultural Land Reserve

Please find attached the Minutes of Resolution # 603/2006 outlining the Commission's decision as it relates to the above noted application. As agent, it is your responsibility to notify your client(s) accordingly.

Yours truly,

PROVINCIAL AGRICULTURAL LAND COMMISSION

Per:

Erik Karlsen, Chair

cc: Thompson-Nicola Regional District (#A-5-1 (N))

SR/lv/Encl.: Minutes/Sketch Plan
36904d1

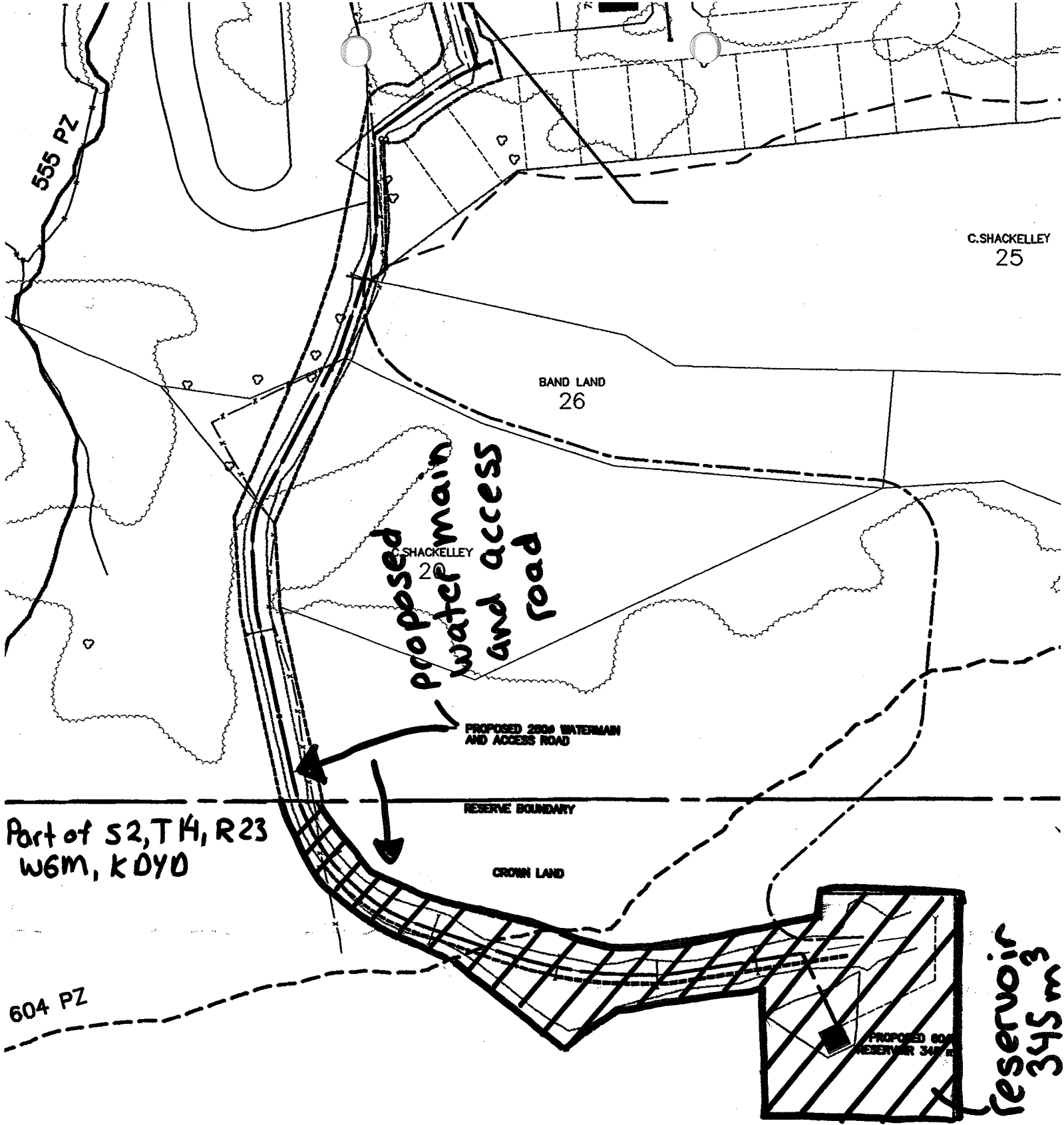

Provincial Agricultural Land Commission

Application ZZ-36904
 Resolution 603/2006

 Approved 2 ha for use as a water reservoir, water main and access road



Reservoir
345 m³



Staff Report
Application # ZZ – 36904
Applicant: 538053 BC Ltd - Nooaitch Indian Band
Agent: Civic Engineering Services Ltd

DATE RECEIVED: September 7, 2006

DATE PREPARED: November 10, 2006

TO: Chair and Commissioners – Interior Panel

FROM: Simone Rivers, Land Use Planner

PROPOSAL: To use 2 ha of the Crown Land within the ALR to construct a water storage reservoir at a elevation of 600 meters or higher to provide peak storage and fire protection to the Main Village Subdivision.

This application is made pursuant to Section 6 of BC Regulation 171/2002
(*Agricultural Land Reserve Use, Subdivision and Procedure Regulation*).

BACKGROUND INFORMATION:

The Nooaitch Band requires a water storage reservoir at elevation 600 m or higher to provide peak storage and fire protection to the Main village Subdivision. The sties of the proposed reservoir is the only suitable location at elevation 600 m which would be accessible to a 4WD vehicle, and is within a reasonable distance of the subdivision . the Ministry of Agriculture and Lands has approved the Band's application for tenure provided that the Provincial Agricultural Land Commission approved the intended use of the land.

The road access has been chosen to keep the water-main and the roadway within the same corridor, to minimize the land area required, and impact to the forest environment. In order to mitigate soil erosion, all disturbed areas will be seeded.

Local Government:

Thompson-Nicola Regional District

Legal Description of Property:

Section 2, Township 14, Range 23, W6M, Kamloops Division of Yale District

Location of Property:

Canford, west of Merritt

Size of Property:

2.0 ha (The entire property is in the ALR).

Present use of the Property:

Crown Land.

Agricultural Capability:

Data Source: Agricultural Capability Map # 921/03
The majority of the property is identified as having Secondary ratings.

ATTACHMENTS:

- Sketch plan showing the area proposed for the water reservoir (Submitted by the agent for the applicant)
- ALC Context Map - Thompson Nicola Regional District Constituents 59 and 60, 1:10,000 (Created by ALC Staff)

END OF REPORT

Signature

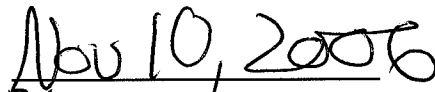
Date