



**Agricultural Land Commission**  
133-4940 Canada Way  
Burnaby, British Columbia V5G 4K6  
Tel: 604-660-7000  
Fax: 604-660-7033  
www.alc.gov.bc.ca

July 5, 2006

Reply to the attention of Ron Wallace  
ALC File: #C-36535

Patrick Ringwood Corporation  
1120 Dallas Road  
Victoria, BC V8V 1B8

Dear Sir/Madam:

Re: **Application to Exclude Land from the Agriculture Land Reserve (ALR)**

Please find attached the Staff Report and the Minutes of Resolution #328/2006 outlining the Commission's decision regarding the above noted application.

By way of a copy of this letter the Commission advises the Registrar of Land Titles that the properties noted in the Staff Report have been excluded from the Agricultural Land Reserve Plan of the Capital Regional District and as such the ALR notation is to be removed from the Certificates of Title.

Yours truly,

PROVINCIAL AGRICULTURAL LAND COMMISSION

Per:

A handwritten signature in black ink, appearing to read 'Erik Karlsen', is written over a white background.

Erik Karlsen, Chair

cc Capital Regional District  
Islands Trust Saturna Island - SA-ALR-2006.1  
Parks Canada, 2220 Harbour Road, Sidney, BC V8L 2P6  
Registrar of Land Titles – Victoria

RW/lv/Encl. minutes  
staff report



36535d1.

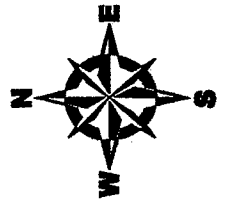

# Gulf Islands National Park Reserve ALR Application



## Legend

-  Subject Parcels
-  ALR
-  Park Reserve



**Staff Report**  
**Application # C – 36535-0**  
**Applicant: Her Majesty the Queen in right of Canada**  
**Agent: Patrick Ringwood**

**DATE PREPARED:** April 12, 2006

**TO:** Chair and Commissioners – Island Panel

**FROM:** Ron Wallace, Regional Research Officer

**PROPOSAL:** This is one of a series of applications for exclusion from the ALR to facilitate the transfer of private and public land to the federal and provincial government for the designation of the new Gulf Islands National park. This application, presented by Patrick Ringwood as agent for the federal and provincial governments, requests the exclusion from the ALR of all the ALR land within the four subject properties on Saturna Island.

This application is made pursuant to section 30(1) of the *Agricultural Land Commission Act*.

**BACKGROUND INFORMATION:**

As the Federal Parks Act requires land to be designated as park to be unencumbered, the proponent asks that the ALR designation be removed from these lands prior to transfer and designation for park.

**Local Government:**

Islands Trust Saturna Island

**Legal Description of Property:**

1. PID: 009-628-355  
The East 1/2 of, Section 1, Saturna Island, Cowichan District, EXCEPT That part in Plan 49833;
2. PID: 008-949-221  
The East 1/2 of the West 1/2, Section 1, Saturna Island, Cowichan District, EXCEPT That Part in Plan 49833;
3. PID: 002-684-217  
Lot A, Section 10, Saturna Island, Cowichan District, Plan 25807;
4. PID: 009-629-033  
The South East 1/4 of, Section 10, Saturna Island, Cowichan District, EXCEPT Part in Plan 25807

**Location of Property:**

East Saturna Island

**Total size of all Properties:**

±50.0 ha

**ALR Area:**

±30.0 ha

**Present use of the Property:**

Vacant park land

**Surrounding Land Uses:**

**WEST:** Park  
**SOUTH:** Park and Ocean  
**EAST:** Park and Ocean  
**NORTH:** Various

**Agricultural Capability:**

Data Source: Agricultural Capability Map # 92B.075  
The majority of the property is identified as having Secondary ratings.

**RELEVANT APPLICATIONS:**

**Application #36383-0**

**Applicant:** Her Majesty the Queen in right of Canada

**Decision Date:** March 07, 2006

**Proposal:** This is one of a series of applications for exclusion from the ALR to facilitate the transfer of private and public land to the federal and provincial governments for the designation as part of the new Gulf Islands National park. This application, presented by Patrick Ringwood as agent for the federal and provincial governments, requests the exclusion from the ALR of all the ALR land within the nine subject properties on Pender Island and Sidney Island.

To exclude land on North Pender Island and Sidney Island that are within the Gulf Islands National Park Reserve

**Decision:** Approved without conditions

**LOCAL GOVERNMENT RECOMMENDATIONS/COMMENTS:**

The Local Trust Committee has no objection to the ALR land being excluded from the Reserve, however, the Local Trust Committee recommends that should the subject land be bought or exchanged with private interest that the land be returned to the ALR.

**STAFF COMMENTS:**

Allow as requested.



**END OF REPORT**

**Signature**

**Date**

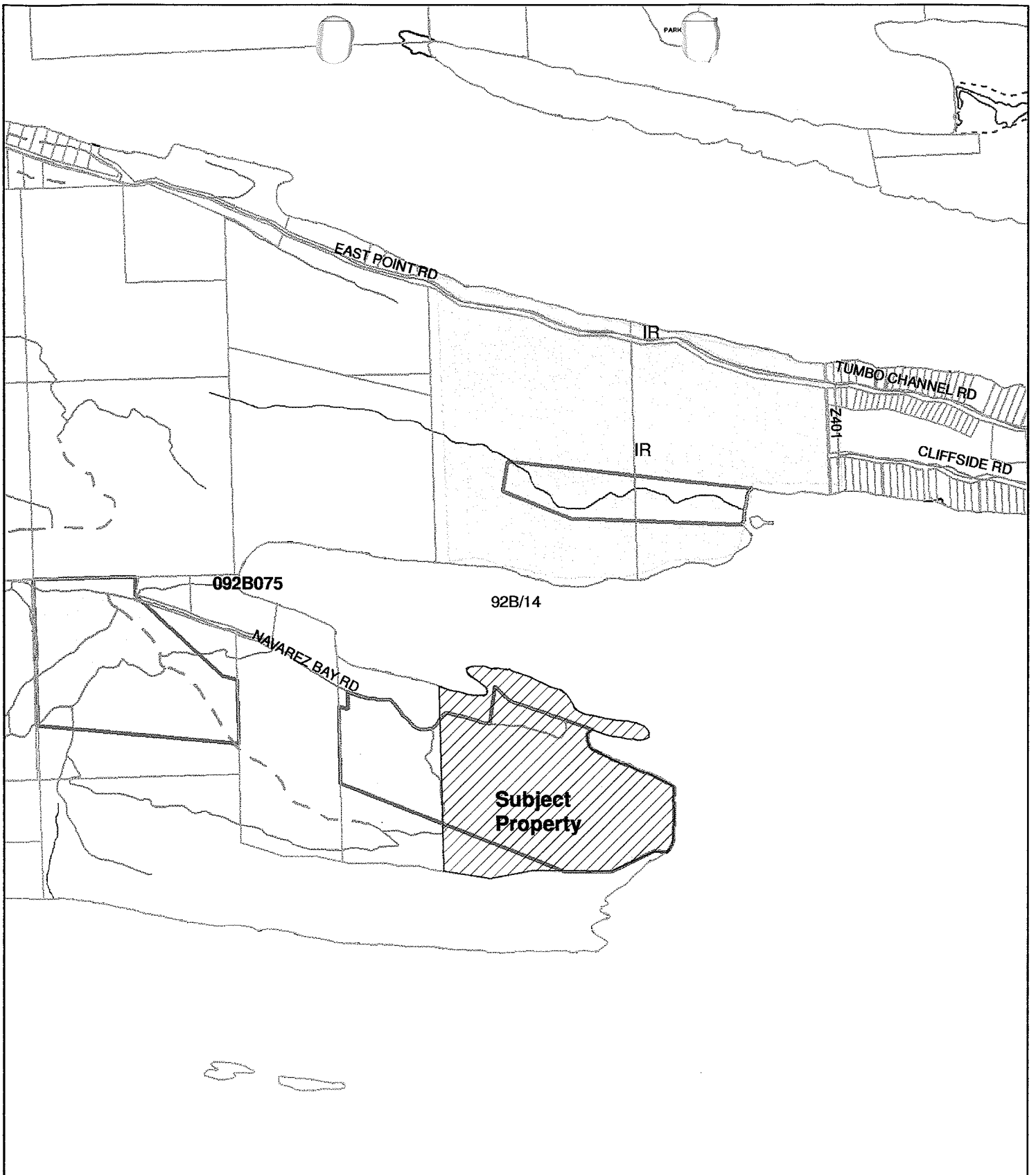

## ALC Context Map

Map Scale: 1:20,000

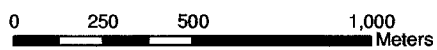

ALC File#:	02-06-36535
BCGS Map Sheet #:	92B.075
Regional District:	Capital