



**Agricultural Land Commission**  
133-4940 Canada Way  
Burnaby, British Columbia V5G 4K6  
Tel: 604-660-7000  
Fax: 604-660-7033  
www.alc.gov.bc.ca

December 1, 2005

Reply to the attention of Simone Rivers

John and Marjory Herrick  
2990 Dog Creek Road  
Williams Lake, BC V2G 4X2

Dear Mr. and Mrs. Herrick:

Re: **Application #B-36272**  
**An Unsurveyed portion of District Lot 5047, Lillooet District**

The Provincial Agricultural Land Commission (the "Commission") has now reviewed your application to include the above noted land ( $\pm$  18.6 ha) into the Agricultural Land Reserve. The application was submitted pursuant to Section 17(3) of the *Agricultural Land Commission Act* (the "ALC Act").

The Commission writes to advise that it approved the application and the inclusion of the above noted land into the Agricultural Land Reserve. The land is now subject to the *ALC Act* and Regulation. The decision noted above is recorded as Resolution #639/2005 and shown on the attached map.

Please quote your application number in any future correspondence.

Yours truly,

PROVINCIAL AGRICULTURAL LAND COMMISSION

Per:

Erik Karlsen, Chair

cc: Integrated Land Management Bureau, 200 – 1488 – 4<sup>th</sup> Avenue, Prince George  
BC V2L 4Y2 (#5406914)  
Cariboo Regional District (#4035-20-E-062)

SBR/lv/Encl.  
36272d1

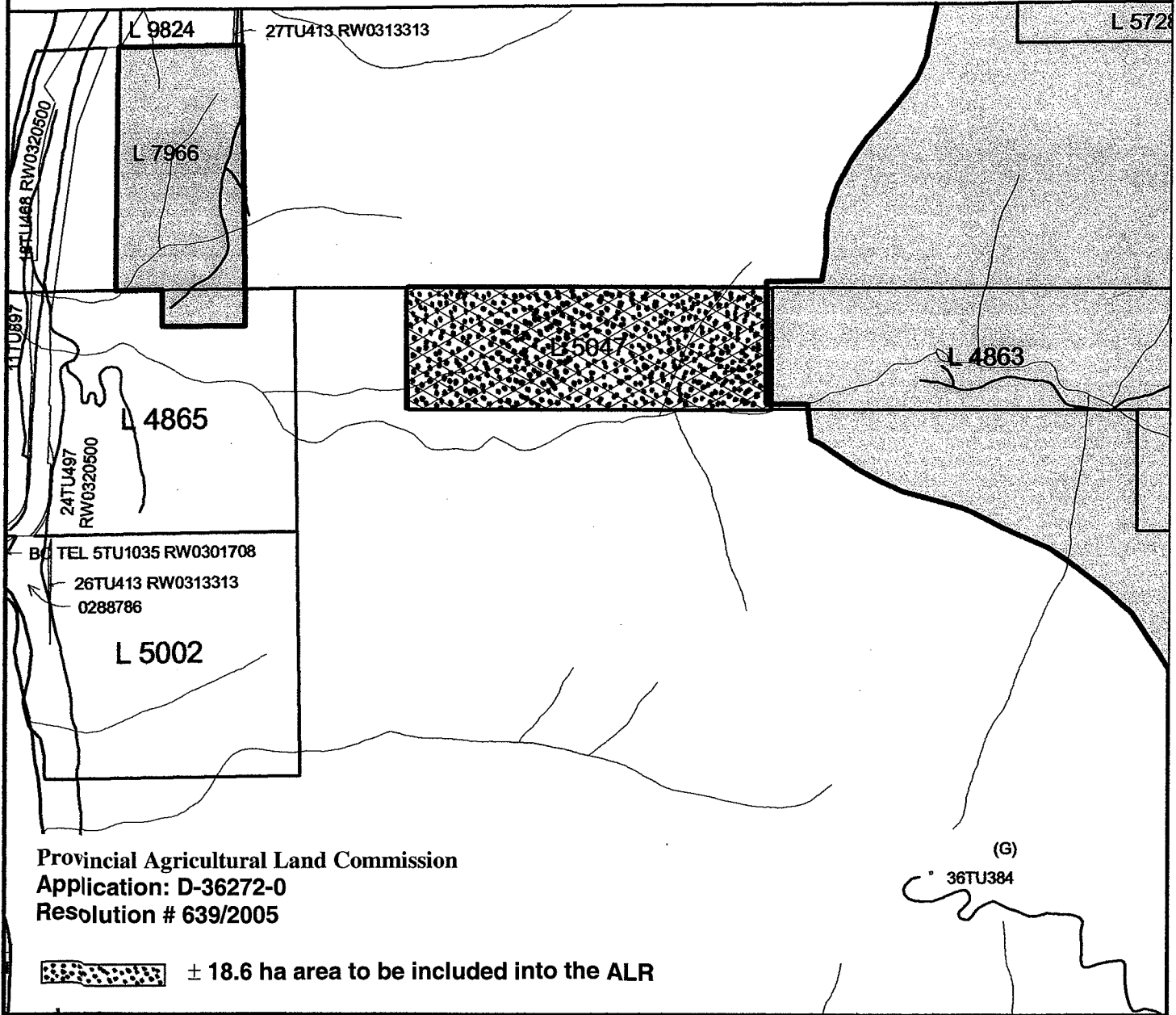

**ALC CONTEXT MAP**  
**Application # 36272**

Map Scale: 1: 20000

ALC File #: 11-05-36272

BCGS Map Sheet #: 920.099

Regional District: Cariboo





**Staff Report**  
**Application # D – 36272 – 0**  
**Applicant: John and Marjory Herrick**  
**Agent: Integrated Land Management Agency**  
**(formerly Land and Water BC Inc.)**

**DATE RECEIVED:** September 21, 2005

**DATE PREPARED:** October 26, 2005

**TO:** Chair and Commissioners – Interior Panel

**FROM:** Simone Rivers, Regional Research Officer

**PROPOSAL:** To include 18.6 ha into the ALR

This application is made pursuant to section 17(3) of the *Agricultural Land Commission Act*.

**BACKGROUND INFORMATION:**

**Local Government:**

Cariboo Regional District

**Legal Description of Property:**

An unsurveyed portion of District Lot 5047 Lillooet District

**Location of Property:**

East of Riske Creek - near DeSous Creek - Williams Lake, BC

**Size of Property:**

18.6 ha

**Present use of the Property:**

Forested

**Surrounding Land Uses:**

**WEST:** Forested (non-ALR)  
**SOUTH:** Forested (non-ALR)  
**EAST:** Agriculture/ forested (ALR)  
**NORTH:** Mountain (non-ALR)

**Agricultural Capability:**

Data Source: Agricultural Capability Map # 92O/16

The majority of the property is identified as having the following ratings. 6:5T-4:4C (6:5TP-4:3P)

**Zoning Bylaw and Designation:**

Cariboo Regional District Central Cariboo Area Rural Land Use Bylaw No. 3505, 1999 designates the parcel as Resource/ Agricultural (R/A) zone.

**OTHER COMMENTS:**

**Ecosystem Biologist, Ministry of Environment:** The Ecosystem Biologist notes that the area under application has been set aside by the Cariboo-Chilcotin Land Use Plan to be managed for mule deer winter habitat. She went on to state that *the region had been dedicated for mule deer by the inter-agency mule deer winter range committee to have a long-term habitat objective of high, indicating that it is to supply the highest range of canopy closure and number of large fir trees. Land alienation is not a compatible use with the maintenance of mule deer winter range.*

In response to a slight amendment of the area as well as additional comments from ILMA staff the biologist still disagreed with the use of this parcel for agricultural purposes. She noted that "we can't find an equivalent area somewhere else to become winter range as it is very site specific."

**Integrated Land Management Agency Staff:** ILMA Staff commented that the location of the subject lands is in an area that will not likely see other demands for land for agricultural purposes in the near future, due to access, terrain and suitability. This proposal does not appear to be in conflict with the crown closure objectives and should not pose a serious impact on the Ungulate Winter Range (UWR).

Staff also note that the consultant's report indicates that the arable lands on the adjoining parcel are fully developed (except for two very small areas) and the recommended parcel is based on the writer's best estimate of similar adjoining lands for terrain and soil, with minor allowances made for a rectangular shape. This has resulted in a decrease in the area applied for from 29.3 ha to 18.6 ha. The consultant's report indicated that this area is 100% arable. This reduction also allows for additional continuity with vegetation cover types beyond the proposed westerly boundary, and for UWR values.

Consolidation with an adjoining lot is a condition of the sale of this Crown land.

---

**END OF REPORT**

*Simone Rivers*  
\_\_\_\_\_  
Signature

*Nov 7, 2005*  
\_\_\_\_\_  
Date

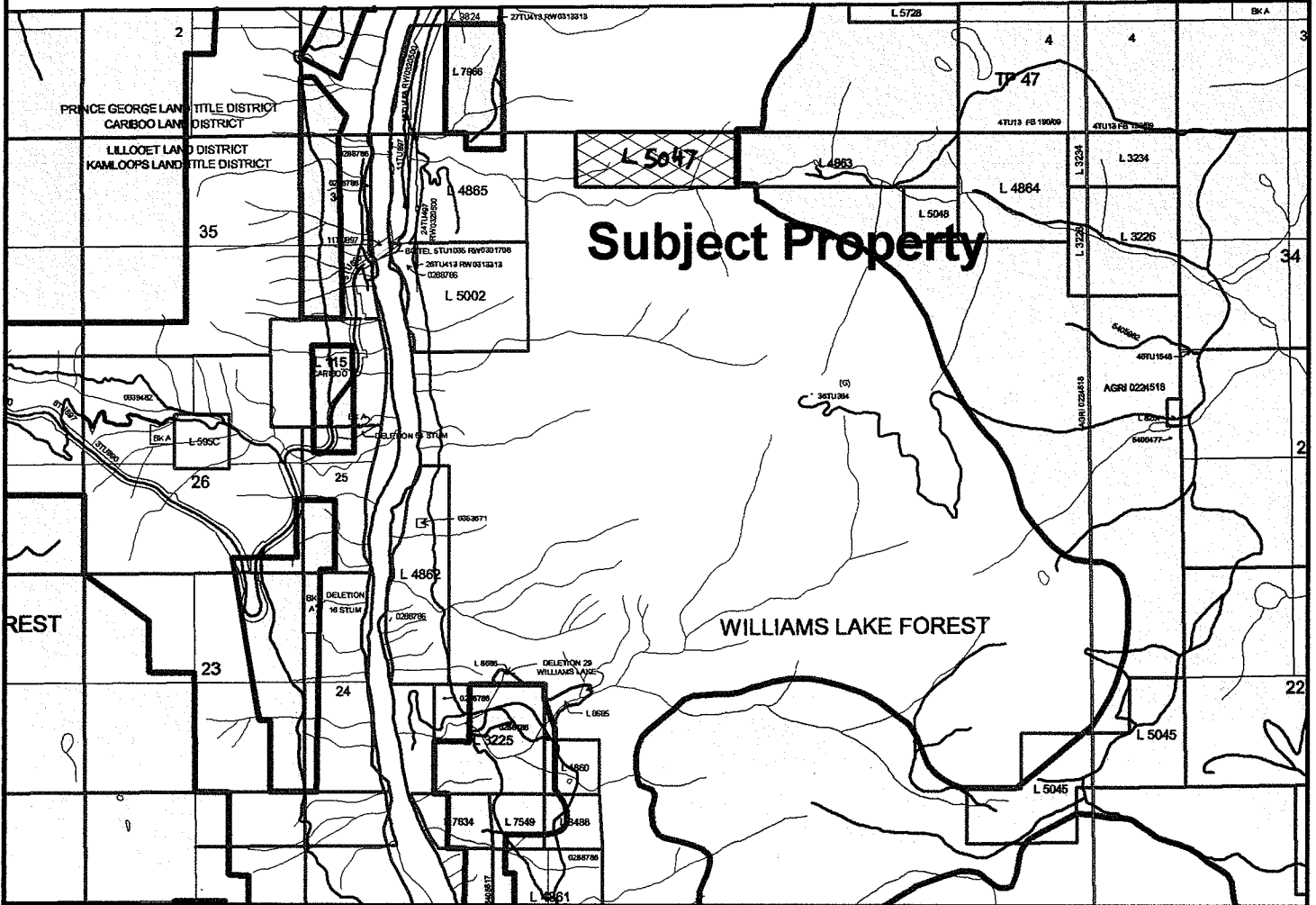

**ALC CONTEXT MAP**  
**Application # 36272**

**Map Scale: 1: 50000**

**ALC File #: 11-05-36272**  
**BCGS Map Sheet #: 920/16**  
**Regional District: Cariboo**