



**Agricultural Land Commission**  
133-4940 Canada Way  
Burnaby, British Columbia V5G 4K6  
Tel: 604-660-7000  
Fax: 604-660-7033  
www.alc.gov.bc.ca

September 6, 2005

Reply to the attention of Ron Wallace

TimberWest Forest 111 Ltd.  
Suite 2300 – 1055 W Georgia Street  
PO Box 11101  
Vancouver, BC V6E 3P3

Attention: Gordon Littlejohn, Director, Real Estate Group

Re: **Application #I-32277 (Jubilee Heights)**

1. PID: 008-888-159  
The South West  $\frac{1}{4}$  of Section 20, Township 1, Comox District, Plan 552,  
Except Part in Plan 37963
2. PID: 008-885-958  
The East  $\frac{1}{2}$  of the South East  $\frac{1}{4}$  of Section 19, Township 1, Comox District,  
Plan 552
3. PID: 008-876-479  
The North West  $\frac{1}{4}$  of Section 17, Township 1, Comox District, Plan 552,  
Except Part in Plans 50189 and VIP62622
4. PID: 008-876-495  
The Fractional North East  $\frac{1}{4}$  of Section 17, Township 1, Comox District, Plan  
552, Except That Part in 23747, 37963 and VIP62622
5. PID: 008-887-314  
The Fractional South East  $\frac{1}{4}$  of Section 20, Township 1, Comox District,  
Plan 552, Except Those Parts in Plans 23747 and 37963.

The Commission, acting under section 33 of the *Agricultural Land Commission Act*, has reconsidered your application to exclude a total of 85.5 ha property from the ALR involving the above noted properties.

Further to the Commission's letter of 24 March 2005 (copy attached) and the subsequent discussions between Deane Strongitharm, City Spaces Consulting Ltd., and Don Rugg, Commissioner – Island Panel, the Commission writes to confirm that it approved your application subject to commitment from TimberWest Forest Corporation (as expressed in a letter dated 10 August 2005 from Deane Strongitharm) to include into the ALR other land (totaling a minimum of 85.5 ha) mutually agreed between the Commission and TimberWest.

The decision noted above is recorded as **Resolution #460/2005**.

TimberWest Forest 111 Ltd.  
Page 2 - #32277

The Commission suggests you arrange for the preparation of a subdivision plan to delineate the approved exclusion area. Please send two (2) paper prints of the final survey plans to this office well in advance of commencing registration at the Land Titles Office. When the Commission confirms that the subdivision plan is acceptable it will authorize the Registrar of Land Titles to accept the application for deposit of the plan and at the same time confirm that the area has been excluded from the ALR.

Please quote your application number in any future correspondence.

Yours truly,

PROVINCIAL AGRICULTURAL LAND COMMISSION

Per:

Erik Karlson, Chair

cc: Deane Strongitharm, City Spaces Consulting Ltd.  
District of Campbell River  
BC Assessment, Courtenay  
Jill Hatfield, Regional Agrologist, Courtenay

RW/lv/32277d5

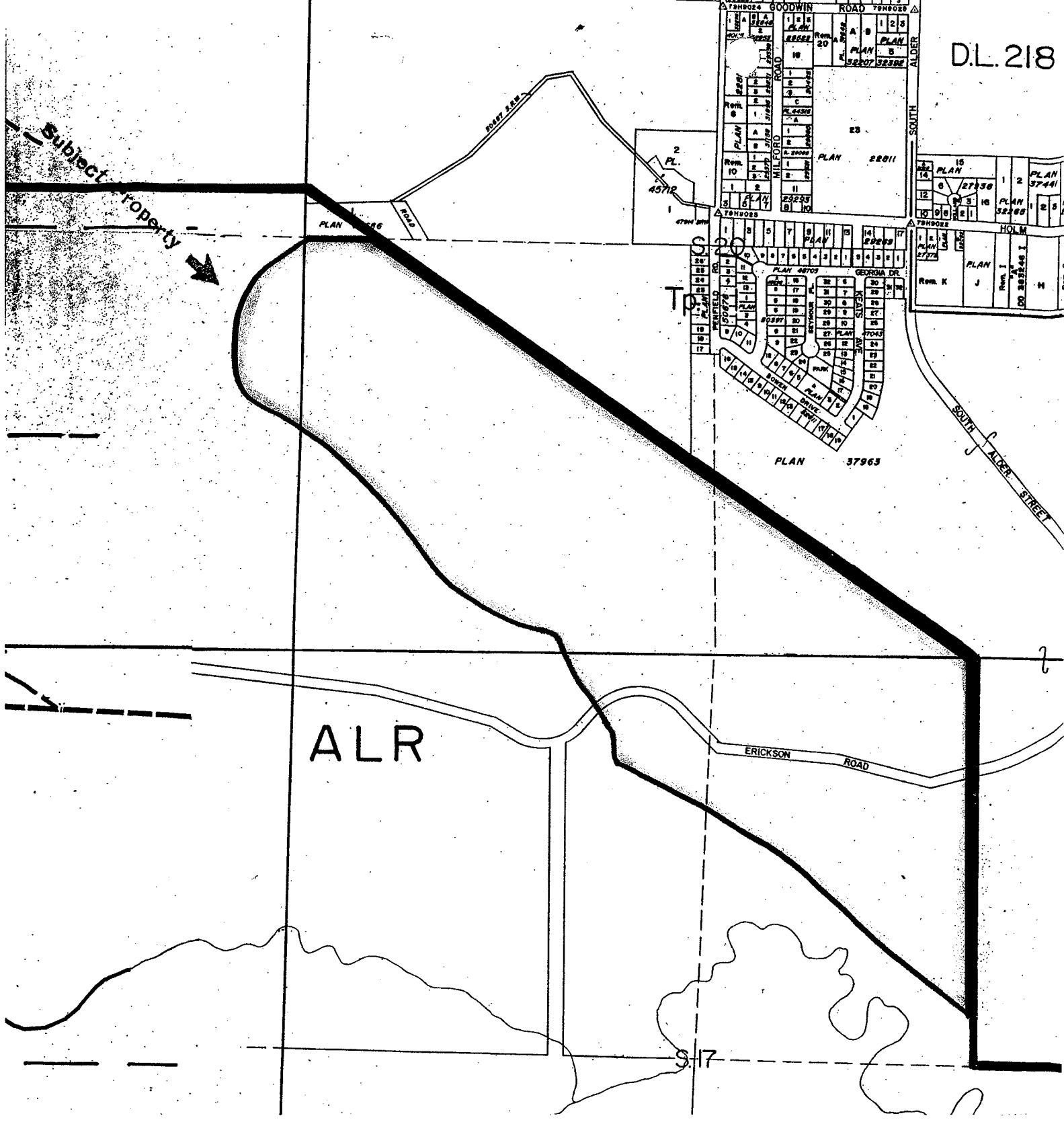

Provincial Agricultural Land Commission  
 Application: I-32277  
 Resolution #460/2005



±85.5 ha area approved for exclusion from the ALR.

