



Agricultural Land Commission
133-4940 Canada Way
Burnaby, British Columbia V5G 4K6
Tel: 604 660-7000
Fax: 604 660-7033
www.alc.gov.bc.ca

July 5, 2013

ALC File: #53168

Hermanjeet Kahlon
Telus Mobile Inc.
#2-3500 Gilmore Way
Burnaby, BC
V5G 4W7

Re: Application for a Telecommunications Tower in the Agricultural Land Reserve

Please find attached the Minutes of Resolution #164/2013 as it relates to the above noted application. The Commission has also attached a sketch plan depicting the decision.

Further correspondence with respect to this application is to be directed to Gordon Bednard.

Yours truly,

PROVINCIAL AGRICULTURAL LAND COMMISSION

Per: 

Brian Underhill, Executive Director

Enclosures: Minutes of Resolution #164/2013
Sketch Plan

cc: Regional District of Bulkley-Nechako (File: 1138)
PO Box 820, Burns Lake, BC V0J 1E0
Ministry of Forests, Lands and Natural Resource Operations, Skeena Region
Bag 6000, 3333 Tatlow Road, Smithers, BC V0J 2N0
Attention: Ross Dingwall

53164d1



Minutes of a meeting held by the Provincial Agricultural Land Commission (the "Commission") on July 4, 2013 at the offices of the Commission located at #133 – 4940 Canada Way, Burnaby, BC.

FOR CONSIDERATION

Application: 53168

Applicant: Telus Mobile Inc.

Proposal: (Submitted pursuant to section 20(3) of the *Agricultural Land Commission Act*)

To establish a telecommunications tower on a 1 ha site (lying mostly in the ALR). The facility is comprised of a 60 meter guy wired tower structure and other buildings which occupy less than 100 m². An access road right of way 30 meters wide by 400 meters long is required to access the new tower through District Lot 3405 and Unsurveyed Crown Land.

Legal: 1) Unsurveyed Crown Land in the vicinity of Mathews Lake, Range 5, Coast District, Containing 2.2 ha more or less; and
2) District Lot 3405, Coast District

Location: North west of Houston off of Eichenberger Road

DELEGATION OF DECISION-MAKING TO THE CHIEF EXECUTIVE OFFICER (CEO)

On June 27, 2011 the Commission delegated decision-making to the CEO by Resolution #016N-2011 (File: 135-45/ALC/CEO/APPL). In accordance with section 27 of the *Agricultural Land Commission Act* the Commission has specified that the following applications may be decided by the CEO.

Criterion 14

Exclusion, subdivision, non-farm use and inclusion applications that are not consistent with any of the existing approved criteria (Criteria 1 - 13) but nonetheless are minor in nature, and in the opinion of the CEO the interests of the Commission would be unaffected by an approval of the application.

DECISION:

After reviewing the entire file material, I, Richard Bullock, Chief Executive Officer of the Commission, am satisfied that the proposal is consistent with Criterion #14 of Resolution #016N/2011 and approve the application on behalf of the Commission. Approval is subject to the following conditions:

- the preparation of a survey/leasehold plan; and
- the road and tower must be completed within three (3) years from the date of this decision.

This decision does not relieve the owner or occupier of the responsibility to comply with applicable Acts, regulations, bylaws of the local government, and decisions and orders of any person or body having jurisdiction over the land under an enactment.

RESOLUTION #164/2013

I CERTIFY THAT THIS IS A TRUE RECORD OF THE DECISION

A handwritten signature in dark ink, appearing to read 'R. Bullock', written over a horizontal line.

Richard Bullock, Chief Executive Officer

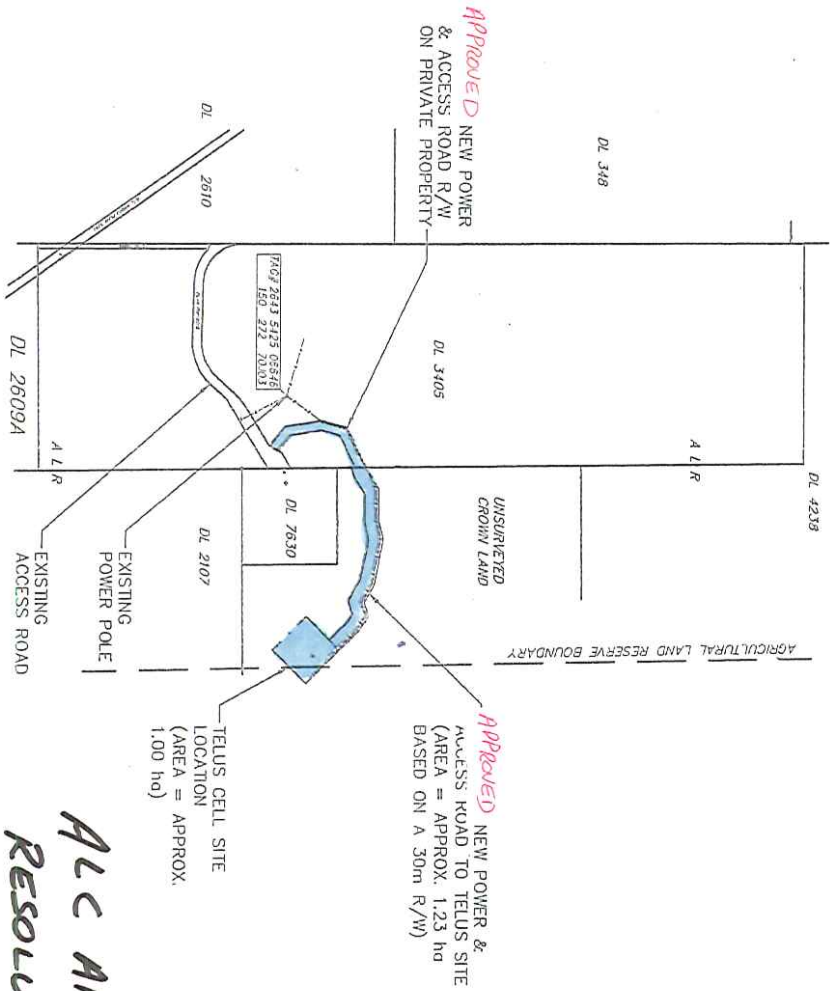

NOTES:

1. UNITS ARE IN METERS.

KEY PLAN

1:10

CO-ORDINATE TABLE					
NAD 83 ZONE 10					
DESCRIPTION	NORTHING	EASTING	LAT.	LONG.	E.L.
CENTER OF TELUS PROPOSED TOWER	6033344.37	648275.88	N54°25'34.21"	W126°42'51.74"	896.07m±

**ALC APPLICATION 53168
RESOLUTION # 164/2013**

REGIONS	BC1776	BC1776	BC1776	BC1776	BC1776
CROWN APPLICATION	BC1776	BC1776	BC1776	BC1776	BC1776
CROWN APPLICATION	BC1776	BC1776	BC1776	BC1776	BC1776
ALC BOUNDARY ADDD	BC1776	BC1776	BC1776	BC1776	BC1776

ROBERTSON KOLBEINS TEVIAN GALLAHER ASSOCIATES LTD CONSULTING ENGINEERS RKTG 1413 W. 4TH AVE. VANCOUVER, BRITISH COLUMBIA V6J 1K4		DRAWING No. B19-5104-100 REV. 3
KEY PLAN DATE: DEC 2011 DESIGNED BY: R. JOHNSON CHECKED BY: R. CARTER APPROVED BY: R. CARTER		DATE: DEC 2011 FROM: 1:1 FROM DATE:
TELUS		