



**Agricultural Land Commission**  
133-4940 Canada Way  
Burnaby, British Columbia V5G 4K6  
Tel: 604 660-7000  
Fax: 604 660-7033  
www.alc.gov.bc.ca

June 11, 2010

Reply to the attention of Brandy Ridout  
ALC File: 51750

Ralph & Helene Sundin  
PO Box 563  
Enderby, BC V0E 1V0

Dear Mr. & Mrs. Sundin:

**Re: Application to Include Land into the Agricultural Land Reserve**

Please find attached the Minutes of Resolution #2494/2010 outlining the Commission's decision as it relates to the above noted application.

As the inclusion condition of Resolution #102/2009 has been met, please send two (2) paper prints of the final survey plans to this office. When the Commission confirms that the plan is in substantial compliance with the plan submitted with application #T-38605, it will authorize the Registrar of Land Titles to accept its registration.

Yours truly,

PROVINCIAL AGRICULTURAL LAND COMMISSION

Per:

A handwritten signature in blue ink, appearing to read 'B. Underhill', is written over the 'Per:' label.

Brian Underhill, Executive Director

Enclosure: Minutes/Sketch Plan

cc: Regional District of North Okanagan (10-0123F-ALR)

BR/  
51750d1



## MINUTES OF THE PROVINCIAL AGRICULTURAL LAND COMMISSION

---

A meeting was held by the Provincial Agricultural Land Commission on June 10, 2010 at the Ministry of Agriculture and Lands Office, located at 200-1690 Powick Road, Kelowna, B.C.

**PRESENT:** Roger Mayer  
Gordon Gillette  
Brandy Ridout

Chair, Okanagan Panel  
Commissioner  
Staff

### For Consideration

Application: 51750  
Applicant: Ralph and Helene Sundin  
Proposal: To include approximately 2 ha of the subject property into the ALR to satisfy a condition of approval under Resolution #102/2009 (application #T-38605).  
Legal: PID: 013-780-638  
That Part North East 1/4, Section 30, Which Lies to the North of the Northern Limit of the Spallumcheen Indian Reserve, Township 18, Range 8, W6M, Kamloops Division of Yale District, EXCEPT Plans B512, B513 and B984  
Location: 77 McNabb Road, Enderby

### Site Inspection

A site inspection was not conducted for the application.

### Context

The proposal was weighed against the purposes of the Commission as stipulated in section 6 of the *Agricultural Land Commission Act* (the "Act"). They are:

1. to preserve agricultural land
2. to encourage farming on agricultural land in collaboration with other communities of interest, and
3. to encourage local governments, first nations, the government and its agents to enable and accommodate farm use of agricultural land and uses compatible with agriculture in their plans, bylaws and policies.

### Discussion

The agricultural capability of the soil of the 2 ha area proposed for inclusion into the ALR is 80% Class 3 with limitations of excess water and soil moisture deficiency and 20% Class 5 with limitations of stoniness and soil moisture deficiency. Class 3 land has limitations that require moderately intensive management practices or moderately restrict the range of crops, or both. Class 5 land has limitations that restrict its capability to producing perennial forage crops or other specially adapted crops.

The Commission noted that the area proposed for inclusion was of mixed prime and secondary agricultural capability and met the intent of its decision under Resolution #102/2009.

**IT WAS**

**MOVED BY:** Commissioner Mayer

**SECONDED BY:** Commissioner Gillette

THAT the application to include approximately 2 ha of the subject property into the ALR to satisfy a condition of approval under Resolution #102/2009 (application #T-38605) be approved.

This decision does not relieve the owner or occupier of the responsibility to comply with applicable Acts, regulations, bylaws of the local government. This includes zoning, subdivision, or other land use bylaws, and decisions of any authorities that have jurisdiction under an enactment.

**CARRIED**

**Resolution #2494/2010**

Enderby Cliffs

Hillside + Bush

- B - Car Port
- C - House
- D - Storage Shed
- E - House
- F - Woodshed
- G - Tool Shed
- H - Storage Shed
- I - Barn

 inclusion

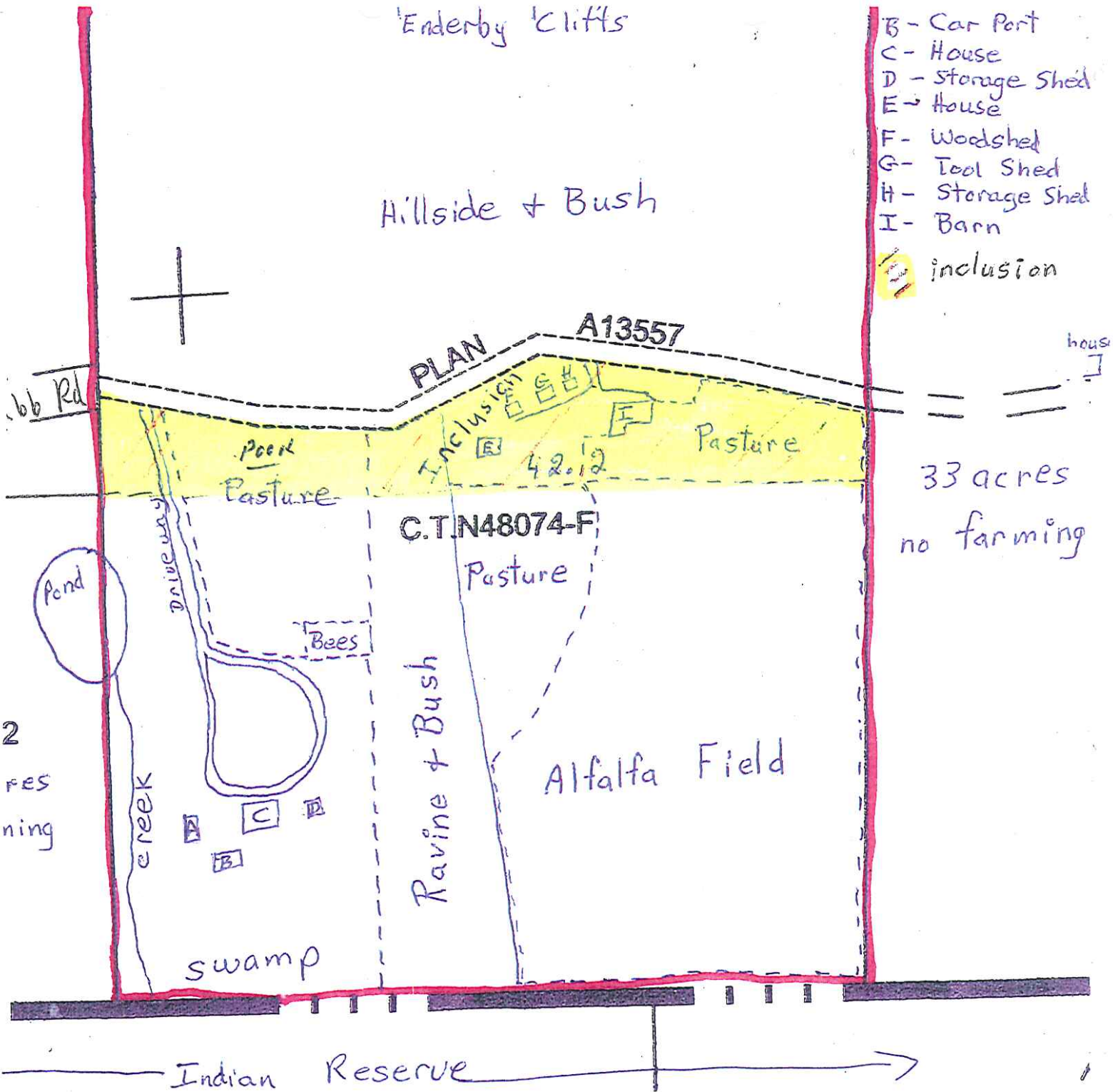

Provincial Agricultural Land Commission  
 Application #51750  
 Resolution #2494/2010

 2 ha area approved for inclusion into the ALR