



**Agricultural Land Commission**  
133-4940 Canada Way  
Burnaby, British Columbia V5G 4K6  
Tel: 604 660-7000  
Fax: 604 660-7033  
www.alc.gov.bc.ca

November 23, 2007

Reply to the attention of Simone Rivers  
ALC File: D-37707

Nigel Hemingway  
c/o Cariboo Geographic Systems  
Box 1270, 490 Cedar Avenue  
100 Mile House, BC V0K2E0

Dear Mr. Hemingway:

**Re: Application to Subdivide land in the Agricultural Land Reserve**

Please find attached the Minutes of Resolution # 607/2007 outlining the Commission's decision as it relates to the above noted application. As agent, it is your responsibility to notify your client(s) accordingly.

Please send two (2) paper prints of the final survey plans to this office. When the Commission confirms that all conditions have been met, it will authorize the Registrar of Land Titles to accept registration of the plan.

Yours truly,

PROVINCIAL AGRICULTURAL LAND COMMISSION

Per:

A handwritten signature in black ink, appearing to read 'Erik Karlsen', is written over the printed name 'Erik Karlsen, Chair'. The signature is fluid and cursive.

Erik Karlsen, Chair

cc: Cariboo Regional District (4035-20-L080)

Enclosure: Minutes/Sketch Plan

**LEGEND**



- Subject Property
- Proposed Lots

0 25 50 100 ALL MEASUREMENTS METRIC m

ALR L 080

DL 2901A

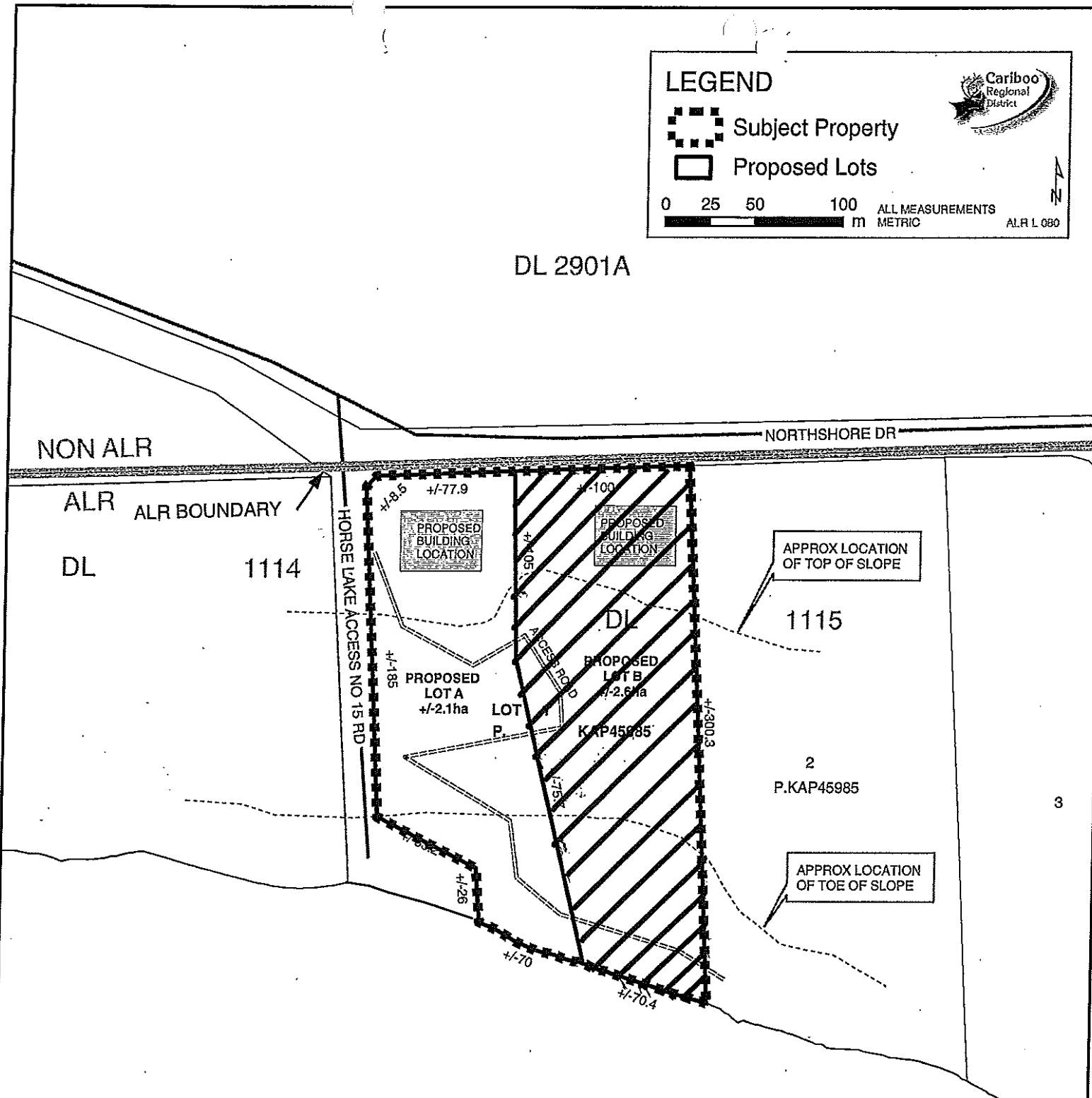

HORSE LAKE

**Provincial Agricultural Land Commission**

Application # D-37707  
 Resolution # 607/2007

- Subject Property
- Approved subdivision



## MINUTES OF THE PROVINCIAL AGRICULTURAL LAND COMMISSION

---

**A meeting was held by the Provincial Agricultural Land Commission on November 7, 2007 at Quesnel City Hall, Quesnel, B.C.**

<b>PRESENT:</b>	Grant Huffman	Chair, Interior Panel
	Holly Campbell	Commissioner
	Gordon Gillette	Commissioner
	Simone Rivers	Staff

### **For Consideration**

Application: # D- 37707  
Applicant: Georg & Annemarie Kellermeier  
Agent: Nigel Hemingway - Cariboo Georgraphic Systems  
Proposal: Subdivide the property of 4.72 ha into two parcels  
Legal: PID: 017-508-509  
Location: Lot 1, District Lot 1115, Lillooet District, Plan KAP45985  
Lakeshore lot on north side of Horse Lake

### **Site Inspection**

A site inspection was conducted on November 5, 2007. Those in attendance were:

- Grant Huffman Chair, Interior Panel
- Holly Campbell Commissioner
- Gordon Gillette Commissioner
- Simone Rivers Staff
- Nigel Hemingway Agent for the applicant

The Commission viewed the subject property which sloped very steeply towards Horse Lake. It drove down the hill to the lake. It also noted that the adjacent properties were small lots. The land to the north of the property was not in the ALR but was likely used for grazing.

Mr. Hemingway confirmed that the staff report dated October 26, 2007 was received and no errors were identified.

### **Context**

The proposal was weighed against the purposes of the Commission as stipulated in section 6 of the *Agricultural Land Commission Act* (the "Act"). They are:

1. to preserve agricultural land
2. to encourage farming on agricultural land in collaboration with other communities of interest, and
3. to encourage local governments, first nations, the government and its agents to enable and accommodate farm use of agricultural land and uses compatible with agriculture in their plans, bylaws and policies.

**Discussion**

**Assessment of Agricultural Capability**

The Commission believed that the subject property had limited agricultural capability due to steep topography and its location next to Horse Lake.

**Assessment of Impact on Agriculture**

The Commission also assessed the impact of the proposal against the long term goal of preserving agricultural land. The Commission does not believe the proposal would impact existing or potential agricultural use of surrounding lands. The subject property is already part of a lakeside subdivision. Although there is less subdivision on the north side of Horse Lake than on the south side the Commission does not believe that the subdivision of this property will have an impact.

**IT WAS**

**MOVED BY:** Commissioner Huffman

**SECONDED BY:** Commissioner Campbell

THAT the application be allowed.

AND THAT the approval is subject to the following conditions:

- the subdivision be in substantial compliance with the plan submitted with the application
- the subdivision must be completed within three (3) years from the date of this decision.

This decision does not relieve the owner or occupier of the responsibility to comply with applicable Acts, regulations, bylaws of the local government, and decisions and orders of any person or body having jurisdiction over the land under an enactment.

**CARRIED**

**Resolution # 607/2007**