



**Agricultural Land Commission**  
133-4940 Canada Way  
Burnaby, British Columbia V5G 4K6  
Tel: 604-660-7000  
Fax: 604-660-7033  
www.alc.gov.bc.ca

October 4, 2006

Reply to the attention of Roger Cheetham  
ALC File: # C - 36850

Capital Regional District  
PO Box 1000 - 625 Fisgard Street  
Victoria, BC V8W 2S6

Dear Sir/Madam:

Re: **Application for Transportation, Utility, and Recreational Trail Use in the ALR**

Please find attached the Minutes of Resolution Number 466/2006 outlining the Commission's decision as it relates to the above noted application.

Yours truly

PROVINCIAL AGRICULTURAL LAND COMMISSION

per:

Erik Karlsen, Chair

RC/eg/Encl.  
36850d1





**Staff Report**  
**Application # C – 36850**  
**Applicant: School District No. 64**  
**Agent: Capital Regional District**

**DATE PREPARED:** August 29, 2006

**TO:** Chair and Commissioners – Island Panel

**FROM:** Colin Fry, Director – Regional Operations

**PROPOSAL:** To create a recreational community park trail (right-of-way) for pedestrians, equestrian and non-motorized vehicles. Bicycle access from Rainbow Road to Mouat Park. The statutory right of way is 3.0 metres wide and totals 0.0573 ha.

This application is made pursuant to section 6 of BC Regulation 171/2002 (*Agricultural Land Reserve Use, Subdivision and Procedure Regulation*).

**BACKGROUND INFORMATION:**

The School District has granted a statutory right of way to the Capital Regional District.

**Local Government:**

Islands Trust – Salt Spring Island

**Legal Description of Property:**

PID: 001-492-292

Block "G" of Section 1, Range 3 East, North Salt Spring Island, Cowichan District, Plan 1371

**Purchase Date:**

Certificate of Title entered on April 10, 1985

**Location of Property:**

229 Rainbow Road, North Salt Spring Island

**Size of Property:**

2.0 ha (The entire property is in the ALR)

**Present use of the Property:**

Vacant

**Surrounding Land Uses:**

North - ALR land used for school playing field purposes and small residential holdings  
East - Farmland and small residential holding  
South - Mouat Park  
West - Mostly forested and hobby farm

**Agricultural Capability:**

Data Source: Agricultural Capability Map # 92B/13  
The majority of the property is identified as having Prime agricultural capability ratings.

**Attachments:**

1. ALC Context Map
2. Explanatory Plan of Statutory Right of Way
3. Aerial Photograph

**END OF REPORT**

Signature

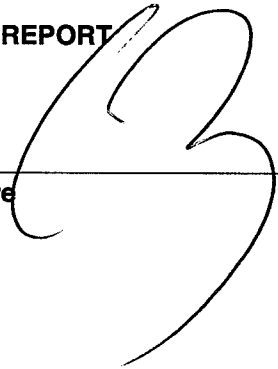
A large, stylized handwritten signature in black ink, appearing to be the initials 'CB', written over a horizontal line.

Date

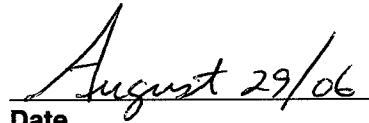
The date 'August 29/06' written in a cursive, handwritten style in black ink, positioned above a horizontal line.

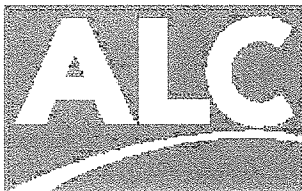
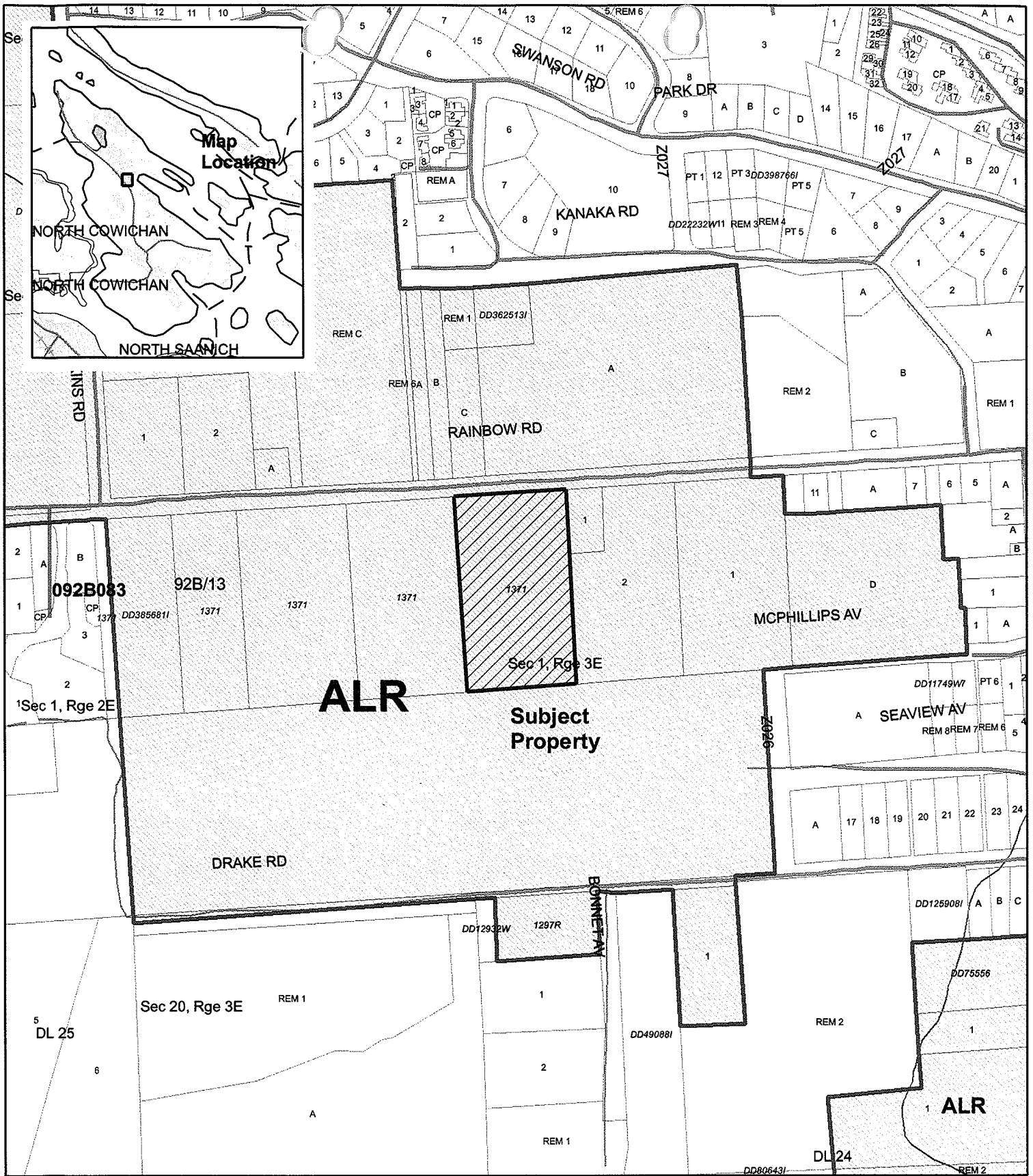

# ALC Context Map

Map Scale: 1:5,000



ALC File#:	21-06-36850
Map Sheet #:	92B.083
Regional District:	Capital