



**Agricultural Land Commission**  
133-4940 Canada Way  
Burnaby, British Columbia V5G 4K6  
Tel: 604-660-7000  
Fax: 604-660-7033  
www.alc.gov.bc.ca

December 1, 2005

Reply to the attention of Simone Rivers

Joseph and Laura Cooper  
PO Box 4506  
Quesnel, BC V2J 3J4

Dear Mr. and Mrs. Cooper

**Re: Application #B-36279**  
**Unsurveyed Crown Land adjacent to District Lot 11823, Cariboo District**

The Provincial Agricultural Land Commission (the "Commission") has now reviewed your application to include the above noted land ( $\pm$  23 ha) into the Agricultural Land Reserve. The application was submitted pursuant to Section 17(3) of the *Agricultural Land Commission Act* (the "ALC Act").

The Commission writes to advise that it approved the application and the inclusion of the above noted land into the Agricultural Land Reserve. The land is now subject to the *ALC Act* and Regulation. The decision noted above is recorded as Resolution #638/2005 and shown on the attached map.

Please quote your application number in any future correspondence.

Yours truly,

PROVINCIAL AGRICULTURAL LAND COMMISSION

Per:

Erik Karlsen, Chair

cc: Integrated Land Management Bureau, 200 – 1488 – 4<sup>th</sup> Avenue, Prince George  
BC V2L 4Y2 (File: 5406866)  
Cariboo Regional District (# 4035-20-I-074)

SBR/lv/36279d1

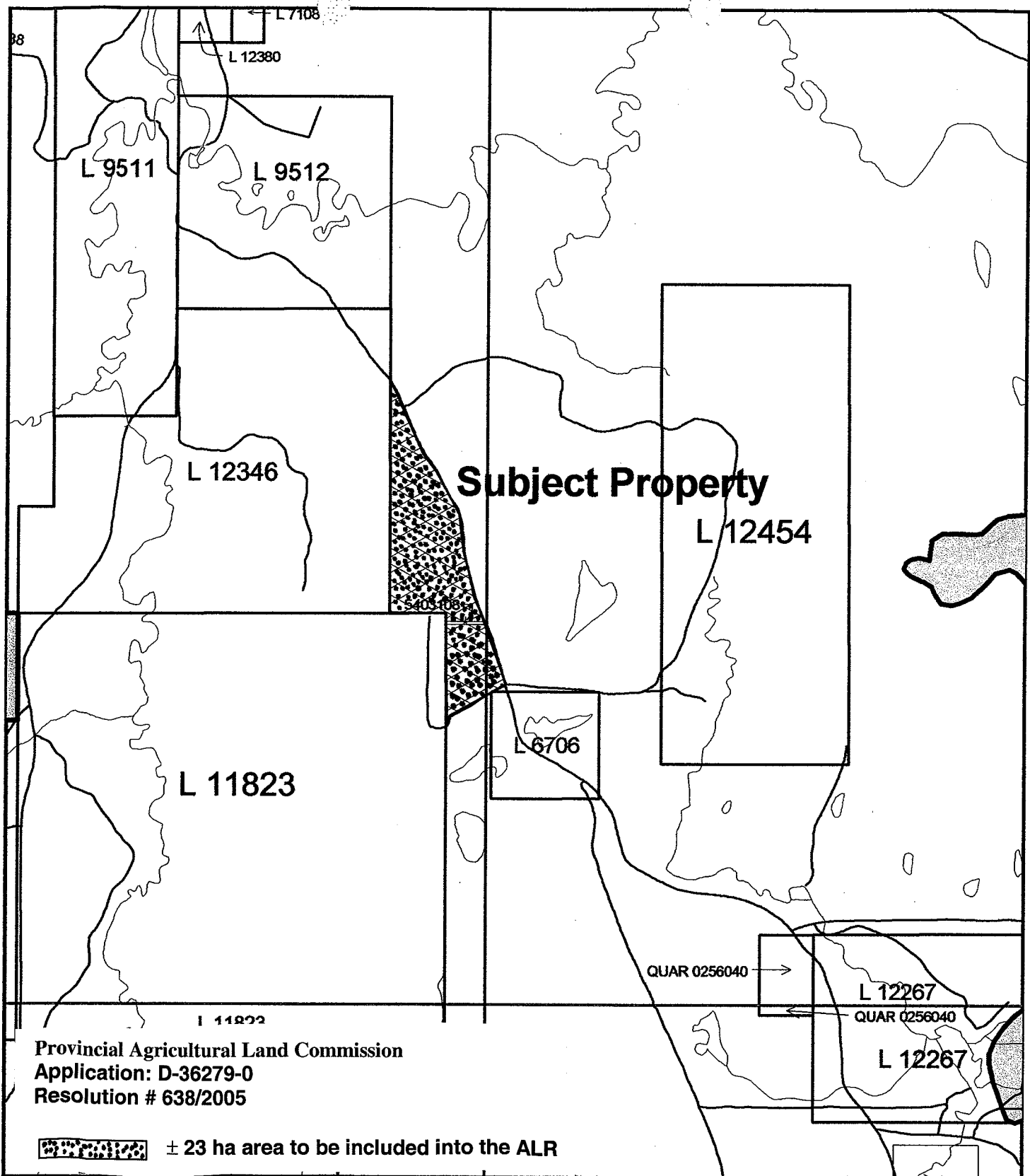

Provincial Agricultural Land Commission  
 Application: D-36279-0  
 Resolution # 638/2005



**ALC CONTEXT MAP**  
 Application # 36279

Map Scale: 1: 20000

ALC File #: 11-05-36279

BCGS Map Sheet #: 93B.095/096

Regional District: Cariboo

**MINUTES OF THE PROVINCIAL AGRICULTURAL LAND COMMISSION**

**Minutes of a meeting held by the Provincial Agricultural Land Commission (the “Commission”) on November 24, 2005 at Quesnel City Hall, 410 Kinchant Street, Quesnel, BC**

**PRESENT:** Grant Huffman Chair  
Holly Campbell Commissioner  
Frank Read Commissioner

**STAFF:** Simone Rivers, Regional Research Officer

**For Consideration**

Simone Rivers presented the staff report dated October 25, 2005 regarding application #D-36279-0.

**Site Inspection**

A site inspection was not conducted.

**Commission Discussion**

The Commission had no objection to the proposed inclusion on the grounds that the land is being Crown granted for agricultural purposes and the application is consistent with the long-standing Memorandum of Understanding (MOU) between the Commission and the Integrated Land Management Bureau (ILMB) (and its predecessors).

**IT WAS**

**MOVED BY:** Commissioner Huffman

**SECONDED BY:** Commissioner Read

**Commission Discussion**

The Commission had no objection to the proposed inclusion on the grounds that the land is being Crown granted for agricultural purposes and the application is consistent with the long-standing Memorandum of Understanding (MOU) between the Commission and the Integrated Land Management Bureau (ILMB) (and its predecessors).

**IT WAS**

**MOVED BY:** Commissioner Huffman

**SECONDED BY:** Commissioner Read

THAT the staff report be received and the application to include ± 23 ha described as Unsurveyed Crown Land adjacent to District Lot 11823, Cariboo District into the ALR be approved on the grounds the proposal was on the grounds the proposal was consistent with the long-standing MOU between the Commission and the ILMB.

This approval is subject to compliance with any other enactment, legislation or decision of any agency having jurisdiction.



**Staff Report**  
**Application # D – 36279 – 0**  
**Applicant: Joseph Edward & Laura Jean Cooper**  
**Agent: Land and Water BC Inc.**

**DATE RECEIVED:** September 28, 2005

**DATE PREPARED:** October 25, 2005

**TO:** Chair and Commissioners – Interior Panel

**FROM:** Simone Rivers, Regional Research Officer

**PROPOSAL:** To include approximately 23 ha into the ALR

This application is made pursuant to section 17(3) of the *Agricultural Land Commission Act*.

**BACKGROUND INFORMATION:**

The land is being sold to the applicant as an extension of their agricultural holdings. A previous application was disallowed due to conflict with an existing Forest tenure, which has now been resolved. The cut block tenure holder has agreed to amend their tenure to accommodate this application. This will add to the existing parcel by provided much needed privacy and will resolve a long standing trespass as the residence is in the north easterly most corner of DL 11823. The parcel will be slightly smaller than applied for as the road at the southerly end of the parcel (and the small amount of land on the south side of the road) will not be sold to the applicant.

**Local Government:**

Cariboo Regional District

**Legal Description of Property:**

Unsurveyed Crown Land adjacent to District Lot 11823, Cariboo District

**Location of Property:**

South of Puntatnkut Lake on Lavington Road, Quesnel

**Size of Property:**

23 ha

**Present use of the Property:**

Vacant Crown land

**Surrounding Land Uses:**

**WEST:** Agriculture (non-ALR)  
**SOUTH:** Forestry /agriculture (non-ALR)  
**EAST:** Forestry / agriculture (non-ALR)  
**NORTH:** Forestry (non-ALR)

**Agricultural Capability:**

No information given

**Zoning Bylaw and Designation:**

Cariboo Regional District North Cariboo Area Rural Land Use Bylaw no. 3505, 1999 designates the parcel as Resource/Agricultural (R/A) zone.

**RELEVANT APPLICATIONS:**

**Application #30274-0**

**Applicant:** Ministry of Environment Lands & Parks  
**Decision Date:** January 12, 1996  
**Proposal:** To include the land into the ALR  
**Decision:** Allowed due to capability and in view of the Protocol Agreement with Lands.

**STAFF COMMENTS:**

Staff recommend that the Commission consider the following. Usually inclusion applications are submitted with an arability analysis of the subject parcel. No arability analysis or any other agricultural capability information was given for the parcel under application. The air photo shows that the land immediately to the west of the subject property is improved for agriculture.

**END OF REPORT**

\_\_\_\_\_  
**Signature**

\_\_\_\_\_  
**Date**

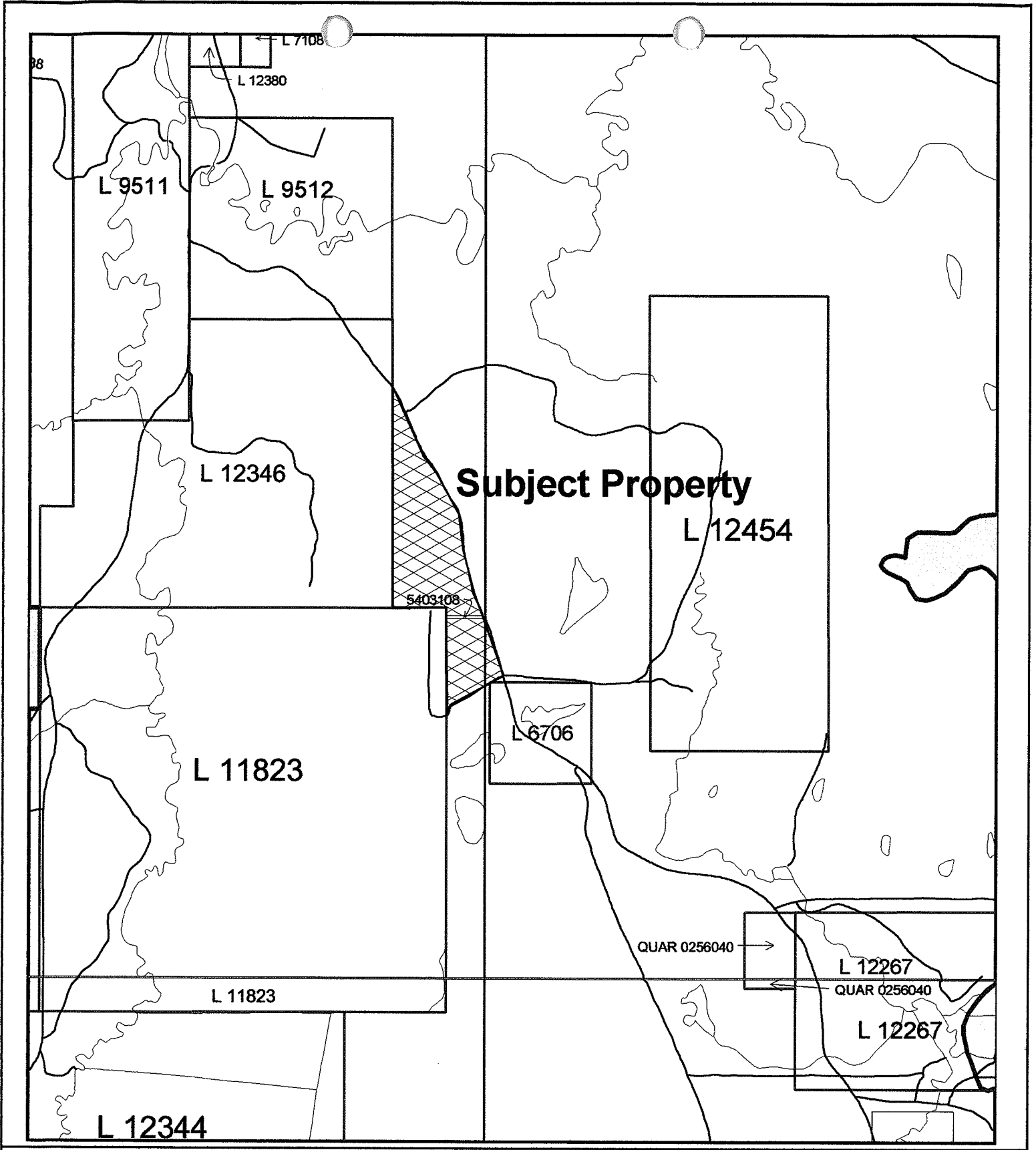

**ALC CONTEXT MAP**  
**Application # 36279**

**Map Scale: 1: 20000**

**ALC File #: 11-05-36279**  
**BCGS Map Sheet #: 93B.095/096**  
**Regional District: Cariboo**