



**Agricultural Land Commission**  
133-4940 Canada Way  
Burnaby, British Columbia V5G 4K6  
Tel: 604-660-7000  
Fax: 604-660-7033  
www.alc.gov.bc.ca

September 23, 2005

Reply to the attention of Simone Magwood

Jason Archambault  
PO Box 366  
MacKenzie, BC – V0J 2C0

Dear Mr. Archambault:

**Re: Application #N-36118-0**  
District Lot 13164, Cariboo District

The Provincial Agricultural Land Commission (the "Commission") has now reviewed your application to include the above noted land (82.3 ha) into the Agricultural Land Reserve. The application was submitted pursuant to Section 17(3) of the *Agricultural Land Commission Act* (the "ALC Act").

The Commission writes to advise that it approved the application and the inclusion of the above noted land into the Agricultural Land Reserve. The land is now subject to the *ALC Act* and Regulation. The decision noted above is recorded as Resolution #483/2005 and shown on the attached map.

Please quote your application number in any future correspondence.

Yours truly,

PROVINCIAL AGRICULTURAL LAND COMMISSION

Per:

A handwritten signature in black ink, appearing to read 'Erik Karlsen', is written over a large, stylized, cursive signature that is mostly illegible.

Erik Karlsen, Chair

cc: Land and Water B.C. 455-1011 4<sup>th</sup> Ave, Prince George, B.C., V2L 3H9  
File: 7408168  
Regional District of Fraser-Fort George (ALR 13164)  
BC Assessment, Prince George

SM/lv/Encl.  
36118d1

Map created Tue Aug 23 12:48:00 PDT 2005

**Legend**

- Survey Points
- TWA Miscellaneous
- 45M Annotation
- TWA - Stations
- TWA - Watersheds
- TWA - Linear Water
- Ice Masses (EBM)
- Glacier
- Icefield
- Landcover - Polygon (EBM)
- Vineyard
- Nursery
- Onshore
- Landform - Polygons (EBM)
- Dry Riverbed
- Esker
- Lembert
- Moraine
- Scree
- Slides
- Volcanic Crater
- Rock Outcrop
- SCGS 120 000 Grid
- Contours (TRIM)
- Contour - Index
- Contour - Index Indefinite
- Contour - Index Depression
- Contour - Index Depression Indefinite
- Contour - Intermediate
- Contour - Intermediate Indefinite
- Contour - Intermediate Depression
- Contour - Intermediate Depression Indefinite
- Area of Exclusion
- Area of Indefinite Contours
- Annotation (TRIM)
- Elevation - Points (TRIM)
- Spot Height
- Mountain Peak
- Miscellaneous Features - Points (TRIM)
- Mound (Horizontal Contour)
- Mound (Vertical Contour)
- Photo Centre
- Circular Point - Permanently Marked
- Landcover - Points (TRIM)
- Landcover - Lines (TRIM)
- Wooded Area
- Nursery
- Cleared
- Landform - Points (TRIM)

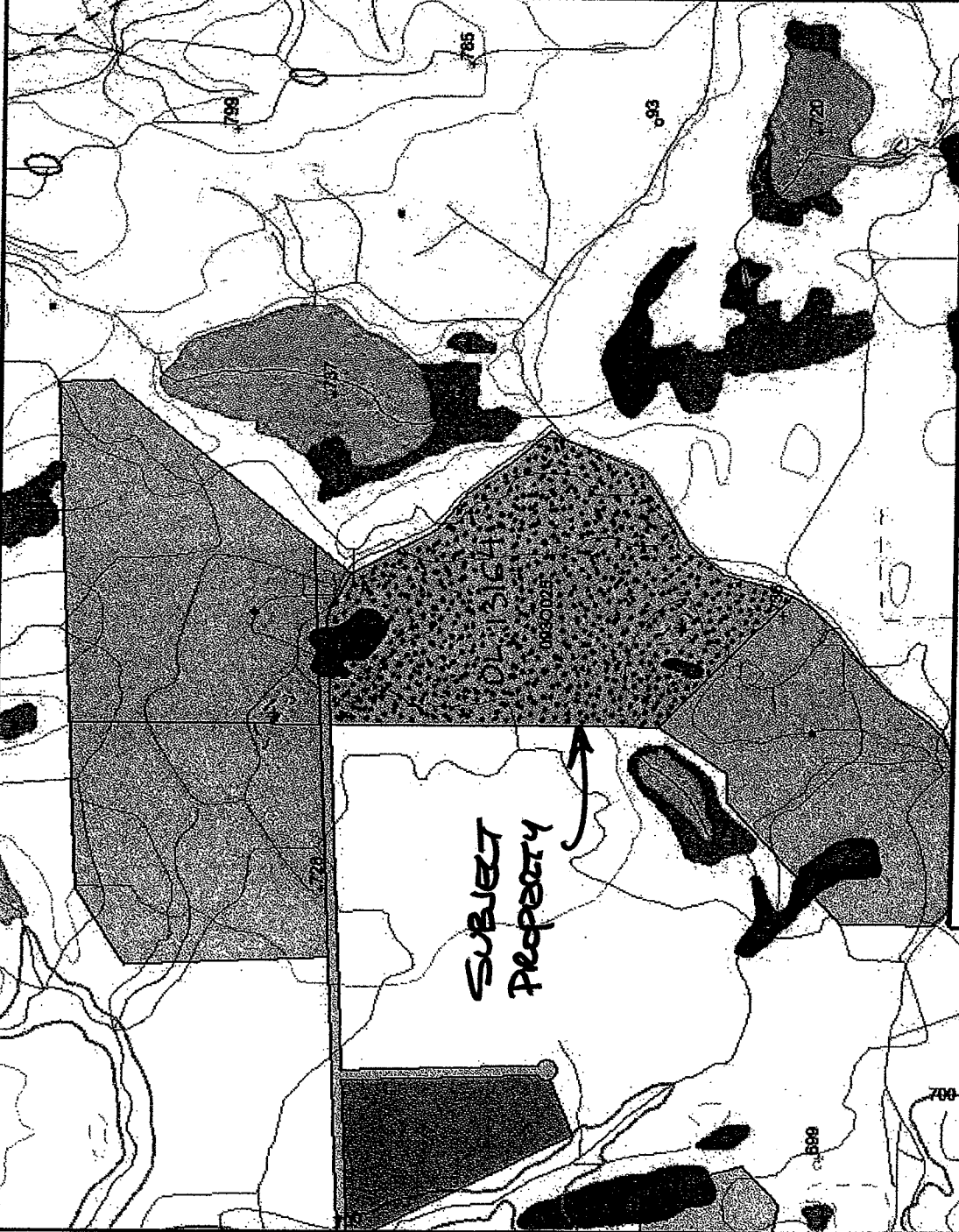

Provincial Agricultural Land Commission  
 Application: D-36118  
 Resolution # 483/2005



± 82.3 ha area to be included into the ALR

Scale: 1:20,000

DO NOT USE FOR NAVIGATION

6° W 55° 16' 43" N







**Staff Report**  
**Application # N – 36118 – 0**  
**Applicant: Jason Archambault**

**DATE PREPARED:** August 24, 2005

**TO:** Chair and Commissioners – North Panel

**FROM:** Simone Magwood, Regional Research Officer

**PROPOSAL:** To include 82.3 ha of land into the ALR

This application is made pursuant to section 17(3) of the *Agricultural Land Commission Act*.

**BACKGROUND INFORMATION:**

Although there is no agricultural capability mapping for this area Land and Water BC state that the parcel is 100% arable. The Commission has recently allowed two inclusions directly north of the subject property.

**Local Government:**

Regional District of Fraser-Fort George

**Legal Description of Property:**

District Lot 13164, Cariboo District

**Location of Property:**

South of MacKenzie

**Size of Property:**

82.3 ha

**Present use of the Property:**

Treed, undeveloped

**Surrounding Land Uses:**

**WEST:** Treed, undeveloped (non-ALR)

**SOUTH:** Treed, undeveloped (non-ALR)

**EAST:** Small water body, undeveloped (non-ALR)

**NORTH:** Two large lots, District of Mackenzie boundary (ALR)

**Zoning Bylaw and Designation:**

The area is not subject to a Zoning Bylaw or to an Official Community Plan

**RELEVANT APPLICATIONS:**

**Application #35943-0**

**Applicant:** Bichon, Ryan & Patricia

**Decision Date:** May 19, 2005

**Proposal:** To include 53.3 ha into the ALR as a result of purchase from the Crown for residential and agricultural use.

**Decision:** Allowed

---

**Application #35944-0**

**Applicant:** Bichon, Ryan & Patricia

**Decision Date:** May 19, 2005

**Proposal:** To include 64.5 ha into the ALR as a result of purchase from the Crown for residential and agricultural use.

**Decision:** Allowed

---

**STAFF COMMENTS:**

Staff recommends that the application be allowed.

---

**END OF REPORT**

**Signature**

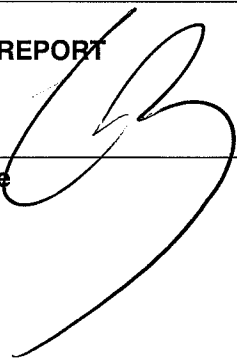

**Date**

*August 24/05*